

# ***GENERATOR***

**EG1000N  
EP1000N**

**PARTS CATALOGUE**

**1**

13Z36D01



EG1000N



EP1000N

---

FOREWORD INDEX

**1**

---

ENGINE GROUP

**2**

---

FRAME GROUP

**3**

---

PART NUMBER INDEX

**4**

---

PART NAME INDEX

**5**

---



**Instruction for use of parts catalogue**

- **This parts catalogue was prepared based on the latest information available as of February 01, 2013.**
- See the parts catalogue news for any revision that is made after February 01, 2013.
- **Always specify the part number when ordering a part.**
  - Check the model, type, serial numbers, color, maker, and the size as needed before ordering a part.
  - Note that the illustrations (part drawings) can differ from the actual parts in shape. They are given just to help you to refer to the parts.
- **When modifications or additions to this parts catalogue are made, a revised edition will be issued at an appropriate time, with successively progressing revision numbers on the cover. We recommend obtaining such revisions in order to keep your parts catalogue up-to-date at all times. To check whether a parts catalogue revision has been issued, please contact your Honda distributor.**

Initial version issue date February 01, 2013  
 Honda Motor Co., Ltd.

**CONTENTS**

	Page	Address No.
● Instruction for use of parts catalogue .....	1	B 1
● How to refer to the part information .....	2	B 2
● Part catalogue structure .....	3	B 3
● When the parts were revised .....	4	B 4
● Abbreviations used in the parts catalogue .....	4	B 4
● How to check the part block and serial numbers .....	5	B 5
● Models, parts catalogue codes and applicable serial numbers .....	6	B 6
● Features of each type .....	7	B 7
● Fuel hose, general purpose hoses and vinyl hose .....	8	B 8
● FLAT RATE SERVICE TIME .....	9	B 9
● Illustrated index .....	14	B14
● ENGINE GROUP .....	18	D 1
● FRAME GROUP .....	37	F 1
● PART NO. INDEX .....	51	G 1
● PART NAME INDEX .....	53	H 1



**1**

**2**

**3**

**4**

**5**

How to refer to the part information

A Reference with "Illustrated index"

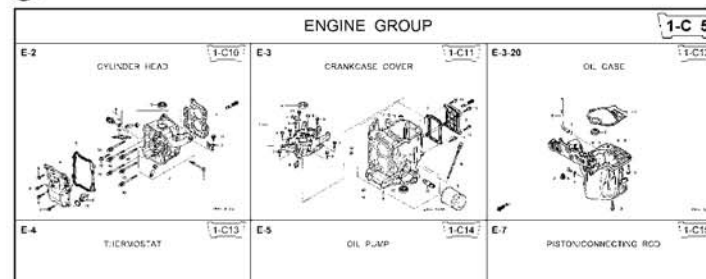

B Reference with "Part number index"

PART NO. INDEX

Part Number	Address	Page	Ref.	Part Number	Address	Page	Ref.
06000				15212-ZW9-000	1-C14	3C	
06316-ZW9-000	1-G9	88	1	15220-ZW9-003	1-C14	3C	
11000				15332-ZW9-000	1-E8	55	
11300-ZW9-405	1-C11	27	1	15332-ZW9-A30	1-E11	56	
11300-ZW9-406	1-C11	27	1	15400-PFB-004	1-C11	27	
11340-ZW9-000	1-C11	27	2	15422-ZW9-000	1-C14	3C	
11342-ZW9-000	1-C11	27	3	15473-881-000	1-C14	3C	
11381-ZW9-003	1-C12	28	1	15474-ZW9-000	1-C14	3C	
12000				15611-921-000	1-C10	2E	
12000-ZW9-405ZA	1-C11	27	4	15655-ZW9-000	1-C11	27	
12155-ZV4-A00	1-C13	29	1				
12166-ZW9-000	1-C10	26	1	16000			
12209-GB4-681	1-C16	32	1	16010-ZV4-005	1-D4	3C	
12210-ZW9-405ZA	1-C10	26	2	16011-ZV4-005	1-D4	3C	
12216-ZE2-300	1-E8	55	1	16013-ZW9-003	1-D4	3C	
	1-E11	58	1	16016-ZW9-003	1-D4	3C	
				16016-ZW9-721	1-D4	3C	
				16023-ZW9-003	1-D4	3C	
				16024-ZV4-650	1-D4	3C	
				16028-ZV4-650	1-D4	3C	

C Reference with "Part name index"

PART NAME INDEX

Part name	Address	Page	Ref.
[ A ]			
ABSORBER , FUEL	1-E15	62	5
ARMATURE COMP.	1-D11	43	7
ARM COMP. , LINK JOINT	1-G6	85	18
ARM COMP. , SHIFT LINK	1-G6	85	14
ARM COMP. , TILT	1-F15	79	20
ARM , FUEL PUMP ROCKER	1-C16	32	4
ARM , REVERSE LOCK	1-F15	79	18
ARM , SHIFT LINK	1-F11	74	7
ARM , STOPPER	1-D1	33	12
ARM , THROTTLE REMOTE	1-F11	74	6
ARM , VALVE ROCKER	1-C16	32	3
[ B ]			
BAG , TOOL , 160MM	1-G5	84	10
BAND	1-G6	86	37
BAND B1 , WIRE	1-F6	69	1
BAND , CORD	1-F3	67	18
BAND , TUBE CLIP , 11MM	1-E15	63	20
BAND , TUBE CLIP , 12.5MM	1-E15	63	19

Address No. 1-C10

Block No. E-2 CYLINDER HEAD

Ref No.

Ref. No.	Part No.	Description	Reqd. QTY						Serial No.	Parts catalogue code
			9901	9901	1001	1001	1001	1001		
1	12166-ZW9-000	STOPPER, ENGINE SIDE	2	2	2	2	2			
2	12210-ZW9-000A	HEAD COMP., CYLINDER								
3	12251-ZW9-003	GASKET, CYLINDER HEAD	1	1	1	1	1			
4	12310-ZW9-000	COVER COMP., HEAD	1	1	1	1	1			
5	12312-ZW9-000	PACKINGS, HEAD COVER	1	1	1	1	1			
6	15611-921-000	CAP, OIL (NO GAUGE)	1	1	1	1	1			
7	16617-ZW9-000	HOLDER, CABLE	1	1	1	1	1		SC,SG	
	16617-ZW9-010		1	1	1	1	1	1001801	LHC,LHD	
			1	1	1	1	1		LHC,LHD	
8	35673-ZV5-003	SENSOR ASSY., WATER	1	1	1	1	1			
9	90003-ZW9-000	BOLT, FLANGE, 6X22	4	4	4	4	4			
10	90007-ZW9-003	BOLT, FLANGE, 6X85	6	6	6	6	6			
11	90011-ZW9-000	BOLT, FLANGE, 6X14(CT200)	1	1	1	1	1			
12	90020-ZW9-000	BOLT, FLANGE, 6X40	2	2	2	2	2			
13	91202-KJ9-003	OIL SEAL, 20X32X6	1	1	1	1	1			
14	91301-805-000	O-RING, 26X2.7	1	1	1	1	1			
15	91307-PK2-005	O-RING, 9.5X1.5(HONDA KIKAKI)	1	1	1	1	1			
16	98059-55916	PLUG, SPARK (CR5EH-D)	2	2	2	2	2			
	98059-55926	PLUG, SPARK (U16FER9)	2	2	2	2	2			

2000.09.20 E

Page No.

Part catalogue structure

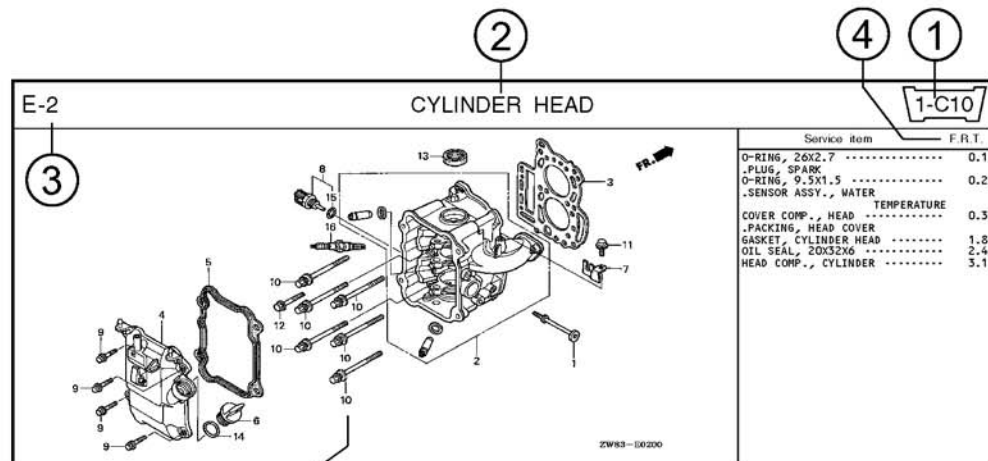

Ref. No.	Part No.	Description	Reqd. QTY						Serial No.	Parts catalogue code
			BF 9/901	BFP 1001	BF 1001	BFP 1061	BF 1061	BFP 1061		
1	12166-ZW9-000	STOPPER, ENGINE SIDE	2	2	2	2	2	2		
2	12210-ZW9-000ZA	HEAD COMP., CYLINDER *NHS* ..... DARK GRAY	1	1	1	1	1	1		
3	12251-ZW9-003	GASKET, CYLINDER HEAD	1	1	1	1	1	1		
4	12310-ZW9-000	COVER COMP., HEAD	1	1	1	1	1	1		
5	12312-ZW9-000	PACKING, HEAD COVER	1	1	1	1	1	1		
6	15611-921-000	CAP, OIL (NO GAUGE)	1	1	1	1	1	1		
7	16617-ZW9-000 16617-ZW9-010	HOLDER, CABLE	1	1	1	1	1	1	----- SC,S6 1001800 LHC,LHD	

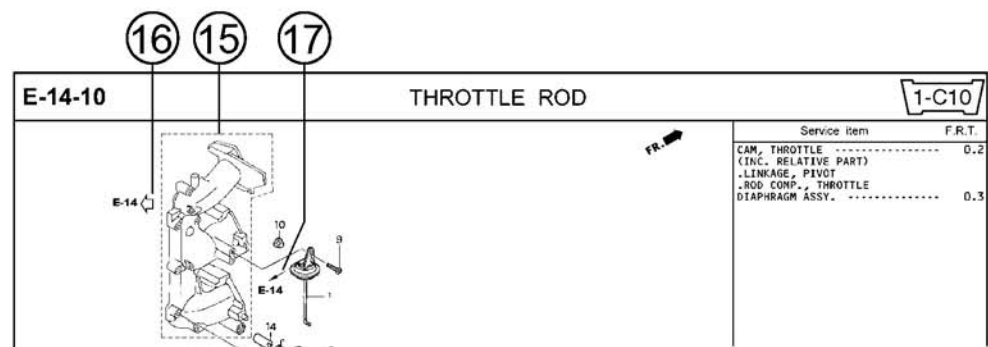

① Address number

• Address No. is provided (in place of the page No.) to help you refer to the part with the part No. or part name.

② Block title ③ Block number

④ Service item/Flat rate time

⑤ Reference number

• Title number marked with the parenthesis or parentheses indicates that it continues from the previous page.

⑥ Part number ⑦ Honda color code

⑧ Description

⑨ Assemblies

• Sections framed with broken lines in the exploded view drawings are available as complete assemblies. (Their individual parts can also be obtained.)

⑩ Color description

⑪ Note

• Notes are shown with the parentheses in the part name column.

⑫ Required quantity

• Required QTY shown in the parenthesis or parentheses indicates the optional part.

• Required QTY marked with "N" Indicates the optional part that should be selected as needed.

• Required QTY indicates the number of the part used in the block.

⑬ Serial number

⑭ Type

• When the type column is blank, it indicates that the part is applicable to all types.

• As the type of the actual unit may differ from the "parts catalogue, type" please refer to "Models, types and applicable serial numbers" for confirmation.

⑮

• Parts enclosed within a dotted line are covered in a different block.

⑯

• A hollow arrow indicates the block No. for the parts enclosed within a dotted line .

⑰

• A solid arrow indicates the block No. the part in question is connected to.

When the parts were revised

Be sure to check the serial number!!



Ref. No.	Part No.	Description	Reqd. QTY						Serial No.
			BF 9.901	BFP 9.901	BF 1001	BFP 1001	BF 1081	BFP 1081	
1	12166-ZW9-000	STOPPER, ENGINE SIDE	2	2	2	2	2	2	
2	12210-ZW9-000ZA	HEAD COMP., CYLINDER							
		*NH8*.....DARK GRAY	1	1	1	1	1	1	
3	12251-ZW9-003	GASKET, CYLINDER HEAD	1	1	1	1	1	1	
4	12310-ZW9-000	COVER COMP., HEAD	1	1	1	1	1	1	
5	12312-ZW9-000	PACKING, HEAD COVER	1	1	1	1	1	1	
6	15611-921-000	CAP, OIL (NO GAUGE)	1	1	1	1	1	1	
7	16617-ZW9-000	HOLDER, CABLE (###)	1	1	1	1	1	1	
	16617-ZW9-010		1	1	1	1	1	1	

The number has been used from the initial model without revision.

When shown at the left side, it is applicable to the models of No.1001801 and the subsequent numbers.

When shown at the right side, it is applicable to the models up to No.1001800.

• The parts listed with "###" at the end of the parts name have limited supply period (parts not for sale).

Abbreviations used in the parts catalogue

• The following abbreviations are used in the parts name column.

- A ..... Ampere
- A.C. .... Alternating current
- ASSY. .... Assembly
- AT. .... Automatic transmission
- C.D.I. .... Capacitive discharge ignition
- COMP. ... Complete
- D.C. .... Direct current
- EX. .... Exhaust
- G.F.C.I ... Ground fault circuit interruptor
- HEX. .... Hexagonal
- H.S.T. .... Hydrostatic transmission
- FR. ....Front
- IN. ....Inlet
- L (100L) .Link (100 Links)
- L. ....Left
- MM .....Millimeter
- MT. ....Manual Transmission
- P.T.O. ....Power take off
- R. ....Right
- RR. ....Rear
- STD. ....Standard
- T (22T) ...Tooth (22 Teeth)
- V ..... Volt
- W .....Watt

How to check the part block and serial numbers

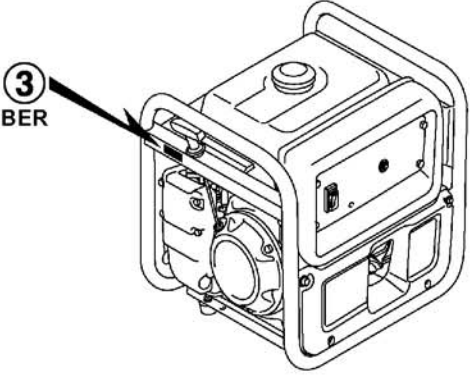
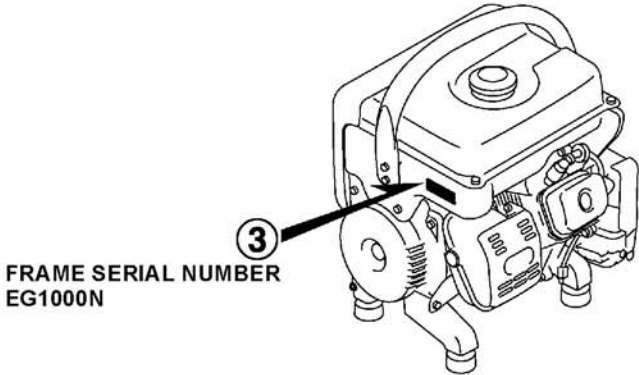
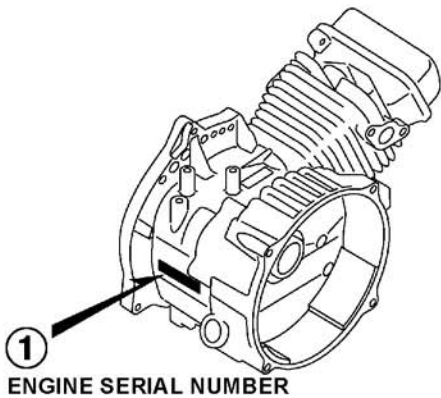
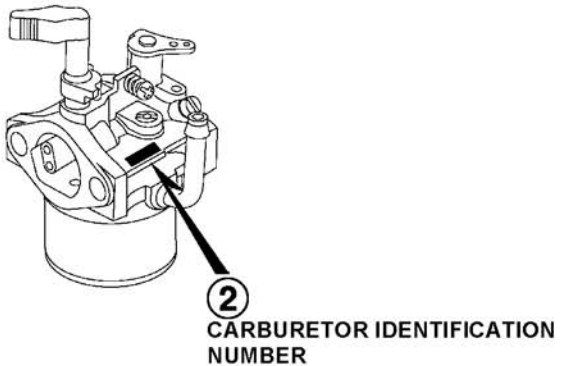
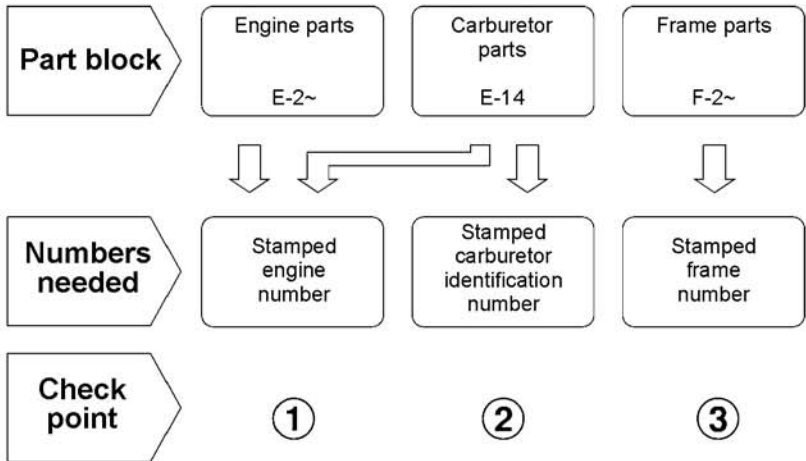

### Models, parts catalogue codes and applicable serial numbers

- Models, parts catalogue codes and applicable serial Nos. given in this parts catalogue can be identified as follows.

Model	Type	Parts catalogue type	Engine		Applicable engine serial No.	Applicable frame serial No.	Applicable carburetor identification No.
			Model	Type			
EG1000N	K	K	GX80D	EY1	GCADD-1000001~	EEGD-1000001~	ZCJA-0034
	L	L		EY4			
	LS	LS		EY6			
	M	M		EY1			
	R	R		EY4			
	RA	RA					
	S	S					
EP1000N	R	R		EY5		EEHD-1000001~	
	RDN	RDN					

\* Of carburetor identification numbers, only the portions underlined in the example below are used for registration.

ZCJA-0034 KC ナ

Features of each type

• See the following table for the features of each type. (Items in brackets are optional)

Specifications		Model	EG1000N						
		Type	K	L	LS	M	R	RA	S
Receptacle	6A/240V								
	10A/250V						●		
	15A/250V	●	●	●	●	●			●
Voltage	120V		●						
	220V				●	●	●	●	
	230V	●		●					
Frequency	50Hz	●			●	●	●		
	60Hz		●	●					●

Specifications		Model	EP1000N	
		Type	R	RDN
Receptacle	6A/240V			●
	10A/250V			
	15A/250V	●		
Voltage	120V			
	220V	●		
	230V			●
Frequency	50Hz	●	●	
	60Hz			

## Fuel hose, general purpose hoses and vinyl hose

1

- The standard part fuel hose, general purpose hose and vinyl hose may be substituted by the coiled bulk part.
- When ordering the standard part fuel hose, general purpose hose and vinyl hose use the bulk part number written in the parts catalog in brackets ( ) underneath the part name.
- When exchanging the hose, cut and use at the specified length as mentioned in the part name.  
(For the method of cutting the bulk part, and method of filling out orders etc., please refer to the instructions issued with the bulk part.)

### Bulk part number of fuel hose, general purpose hose and vinyl hose.

Example: 9 5 0 0 1 - 7 5 0 0 1 - 5 0 M

**Bulk part number:**  
Refers to the bulk part.

**Marking code (fuel hose and general purpose hose)**

**Change code (Vinyl hose)**

Indicates number mark or change sequence, however, the code for the bulk part must be strictly 0 (zero).

**Types of code:**

- Fuel hose
  - 2: Red outside braid (3 mm inside dia. only)
  - 5: Black inside braid
  - 3: Red (3 mm inside dia. only)
  - 4: Ash gray with red stripe (3 mm inside dia. only)
  - 6: Black

- General hose
  - 1: Ash gray
  - 2: Ash gray
  - 3: Black
  - 5: Black

- Vinyl hose
  - 1: Clear
  - 2: Black
  - 3: Light red
  - 6: Light red
  - 7: Pale black

**Lengths:**

- 001: 1 m (standard)
  - 003: 3 m
  - 008: 8 m
- Application or specification of some parts is not settled.

**I.D code: (fuel hose and general purpose hose)**

- |            |                    |                    |                             |                             |
|------------|--------------------|--------------------|-----------------------------|-----------------------------|
| 30: 3.0 mm | 50: 5.0 mm         | 70: 7.0 mm         | 11: 11 mm                   | 12: 12 (outside dia. 17) mm |
| 35: 3.5 mm | 55: 5.3 mm, 5.5 mm | 75: 7.3 mm, 7.5 mm | 91: 12 (outside dia. 15) mm | 14: 14 mm                   |
| 45: 4.5 mm | 65: 6.5 mm         | 80: 8.0 mm         | 92: 12 (outside dia. 16) mm | 17: 17 mm                   |

**ID./OD. code: (vinyl hose)**

- |                         |                          |                           |                           |                           |
|-------------------------|--------------------------|---------------------------|---------------------------|---------------------------|
| 01: ID. 2.9, OD. 6.8 mm | 12: ID. 5.0, OD. 7.0 mm  | 21: ID. 8.0, OD. 9.0 mm   | 37: ID. 11.0, OD. 15.0 mm | 50: ID. 16.0, OD. 19.0 mm |
| 03: ID. 3.0, OD. 6.0 mm | 10: ID. 5.0, OD. 8.0 mm  | 23: ID. 8.0, OD. 12.0 mm  | 38: ID. 12.0, OD. 13.0 mm | 55: ID. 17.5, OD. 20.5 mm |
| 05: ID. 3.5, OD. 6.5 mm | 11: ID. 5.0, OD. 9.0 mm  | 25: ID. 9.0, OD. 11.0 mm  | 39: ID. 12.0, OD. 14.0 mm | 60: ID. 22.0, OD. 27.0 mm |
| 07: ID. 4.0, OD. 7.0 mm | 14: ID. 6.0, OD. 9.0 mm  | 27: ID. 9.0, OD. 13.0 mm  | 40: ID. 12.0, OD. 16.0 mm |                           |
| 08: ID. 4.5, OD. 6.5 mm | 17: ID. 7.0, OD. 9.0 mm  | 33: ID. 10.0, OD. 14.0 mm | 43: ID. 13.0, OD. 15.0 mm |                           |
| 09: ID. 4.5, OD. 8.0 mm | 19: ID. 7.0, OD. 11.0 mm | 36: ID. 11.0, OD. 13.0 mm | 45: ID. 14.0, OD. 18.0 mm |                           |

**Hose type:**

- 1: Fuel hose
- 3: Vinyl hose
- 5: General hose

⊙ **CAUTION: It is DANGEROUS to confuse the fuel hose with the general purpose hose or vinyl hose.**

Never use a general purpose hose or vinyl hose in place of a fuel hose or vice versa. Always use the correct bulk part in the parts catalogue, according to the service manual or the instructions issued with the bulk part.

## FLAT RATE SERVICE TIME

Flat rate service time (FRT) means the standard time required to service a product, which is listed in this manual to help the dealers control the actual working process and calculate the service charge by using it as a guide.

### FRT setting system

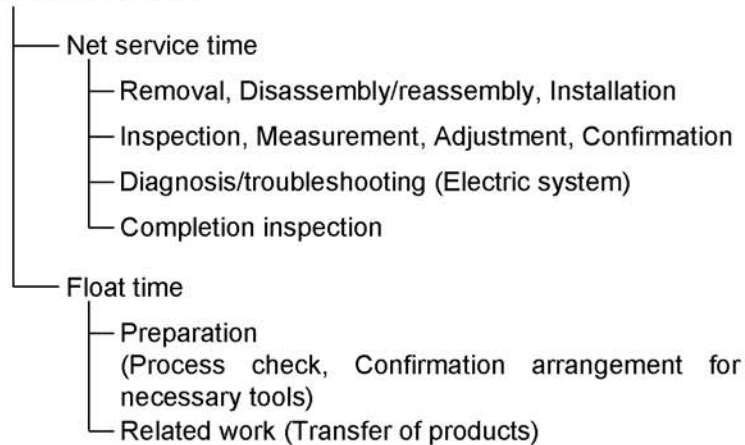

\* Float time is set by multiplying the net service time by a given coefficient.

### Editorial style

The service items shown in the text are listed with the exchange work time for the repair sales parts as the subject. Other representative service items not using repair parts (removal/installation, adjustment, inspection/measuring, and other work) are listed collectively in the list in the preface, classified according to the work.

### FRT setting standard

- Decimal system (in unit of 0.1) is adopted to set FRT as it is convenient to calculate the wage.  
Example: (0.1) → 6 minutes, (0.2) → 12 minutes  
[Labor cost per hour] x [FRT] = [Wage]
- FRT is set with a hand tool.
- Service items and FRT can be subject to change depending on development of tools and service equipment and improvement in service procedure.

### Work procedure

- As the work procedure is set with the work time according to the method in the separate Service Manual, refer to this Manual as required.
- Work methods permitting servicing in the shortest time still permitting assurance of safe work and product warranty are used for the setting of service items not listed in the Service Manual.
- Work basically is to be performed by one person, and when two or more people are required, setting is done as the total time for the number of people.
- The set value for the technological level of the workers uses a person with three years of experience in the repair of Honda products as the standard.
- Special tools and service equipment used to set FRT are those specified or recommended in Service Manual.

### Service item whose FRT is not presented

- Accessories and service parts that are not listed to use in this manual.
  - Locations with little aging deterioration or breakage during normal use.
  - Service work that can be finished by one touch.
  - Service work that is seldom done (i.e. extremely small causes of trouble and service frequency).
  - Products and parts whose location for installation differs according to its status of use and application.
- \* When FRT is not presented, please calculate wages based on appropriate actual work time.

### Operation not included of FRT

- Oil and coolant water draining, Waiting time for warming up operation and etc..
- Additional operation that involves removal/installation of standard exterior equipment.
- Indirect time spent for service by visiting the customer, trade-in, and delivery.
- Indirect time required for ordering and delivery of parts.
- Cost for grease, adhesive agent, etc. used for service work.

**Explanation of FRT by using an example  
(The example may differ from the actual presented items)**

Ref. No.	L.O.N.	(Relative ref. Number) Description	F.R.T.
①	1111L1	(1, 3, 4, 7) VALVE, INTAKE ..... 4.1	②
③	1111L1A	• NOTE: OHV type • Includes: Engine removal and installation One head (intake all) add ..... 1.4	⑤

- ① Reference No. of the illustration of part that shows location of the replacement work.
- ② FRT is an abbreviation of Flat Rate Time indicating the standard service time required for the replacement.
- ③ LON is an abbreviation of Labor Operation Number, and it is a classification of the service items by the work unit code.

The same operation code is used regardless of the models.

Standard operation is indicated with 6 digits code, and additional operation is indicated with 7 digits code.

- ④ Indicating the intake valve replacement and FRT4.1.
- ⑤ Indicating FRT1.4 that will be added when additional operation (whole intake side of one cylinder head) is done in association with intake valve replacement.

- ⑥ Indicating work condition or application condition of the service item.
- ⑦ Indicating work contents that are included in the service item.
- ⑧ Indicating a reference No. whose operation and time are the same as FRT4.1 for the intake valve.

(The application range is limited to the service items without an LON setting within a same block.)

**How to refer to the service item by using the sample  
(intake valve replacement)**

Open to the page of the block where the intake valve's spare part illustration is shown.



Look for the intake valve illustration, and refer to the service item and FRT that agree with the reference No.

Indication mark for the listing of service items that continues to the following page

Ref. No.	L.O.N.	(Relative ref. Number) Description	F.R.T.
2	1111L1	VALVE, INTAKE .....	4.1
	.	.	.
	.	.	.

+  
Mark indicated at the last line.

Indication of the block with no setting of FRT

Ref. No.	L.O.N.	(Relative ref. Number) Description	F.R.T.
NO INFORMATION .....			

• LON code system

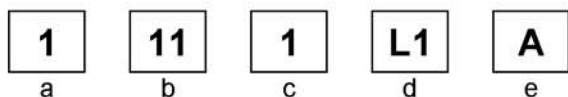

- a) Category code..... Engine
- b) Location/function code ..... Engine upper
- c) Operation code..... Replace
- d) Operation sequence number (Unit code can be shown with alphabet)  
..... Intake valve  
(No regular rule of code)
- e) Additional code ..... One head (intake all)  
(No regular rule of code)

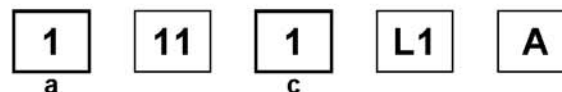

a) Category codes and classification

Code	Category
1	Engine
2	Power drive
3	Fuel & Exhaust
4	Frame & Body
5	Steering
6	Electrical
7	Axle & Brake
8	Control system
9	-
0	Attachments

c) Operation codes and classification

Code	Operation category
1	Replace, Removal/Installation, Change
2	Overhaul
3	Adjust, Rotation
4	(Paint-related work: Top-coat)
5	Test, Inspect/diagnose, Measurement
6	(Overhaul-related work: Rebore)
7	(Overhaul-related work: Reseal)
8	(Resurface)
9	(Paint-related work: Refinish)
0	Repair, Cleaning, Air bleeding

Major service items without using spare parts

- (1) Removal/Installation, (2) Adjustment,  
(3) Inspection/Masurement, (4) Overhaul, (5) Other work

E: Engine, T: Transmission, D: Drive system,  
B: Body and related parts

### (1) Removal/Installation

Set with the parts configuration in the status of being removed from the product.

	LON	DESCRIPTION	FRT
E	1001A0	ENGINE AND GENERATOR-REMOVAL/INSTALLATION	0.9
	1111L3	CYLINDER HEAD ASSEMBLY-REMOVAL/INSTALLATION INCLUDES: Engine-removal/installation	1.6
	1111AB	CYLINDER HEAD ASSEMBLY-REMOVAL/INSTALLATION(A) NOTE: EG model	1.1
B	6221R4	CONTROL BOX ASSEMBLY-REMOVAL/INSTALLATION	0.2

### (2) Adjustment

	LON	DESCRIPTION	FRT
E	1113A1	VALVE CLEARANCE-ADJUSTMENT NOTE: For 1 product	0.3
	3113A2	CARBURETOR IDLE-ADJUSTMENT	0.2

### (3) Inspection, Measurement, Cleaning

	LON	DESCRIPTION	FRT
E	1105A0	ENGINE OIL-INSPECTION	0.1
	3115A2	CARBURETOR FLOAT LEVEL-MEASUREMENT	0.6
	3120A0	AIR CLEANER-CLEANING INCLUDES: Air cleaner-inspection	0.2
	6140A0	SPARK PLUG-ADJUSTMENT/CLEANING INCLUDES: Spark plug check NOTE: For 1 product	0.2

### (4) Overhaul

Work condition: The required Measurements, inspections, adjustments, and cleaning/washing of each part are performed, including the main body removal/installation work and the replacement of defective parts.

	LON	DESCRIPTION	FRT
E	3112A0	CARBURETOR-OVERHAUL INCLUDES: All necessary adjustment	0.8

### (5) Other work

	LON	DESCRIPTION	FRT
E	1101E1	ENGINE OIL-CHANGE INCLUDES: Engine oil-inspection	0.1

# ENGINE GROUP

**B14**

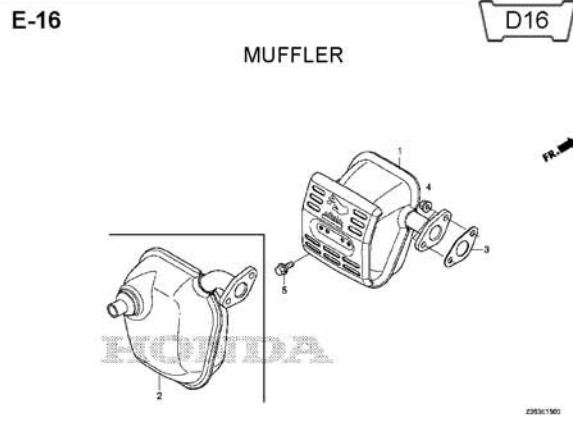
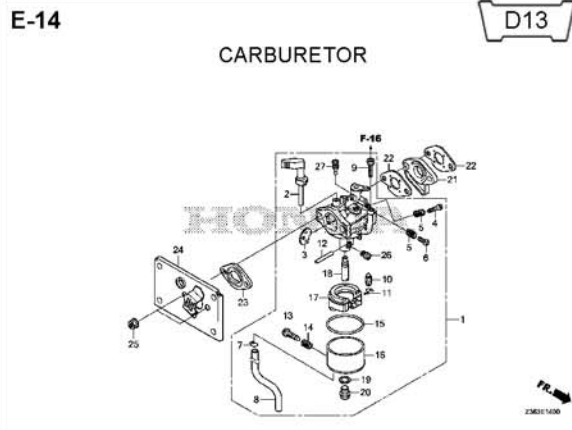
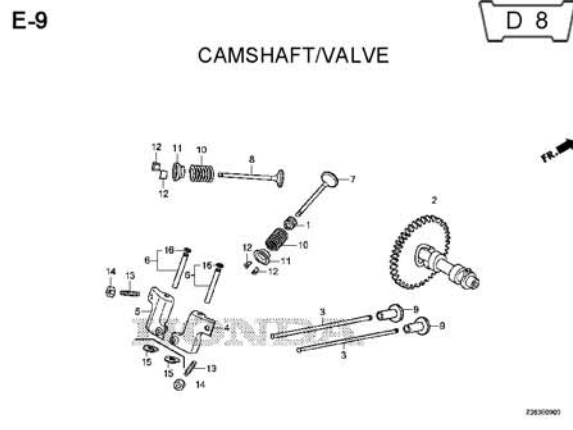
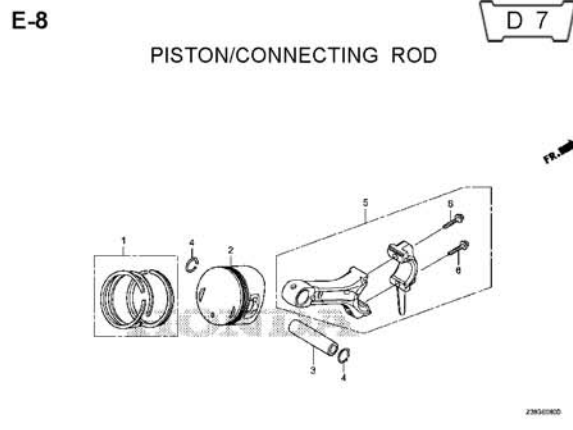
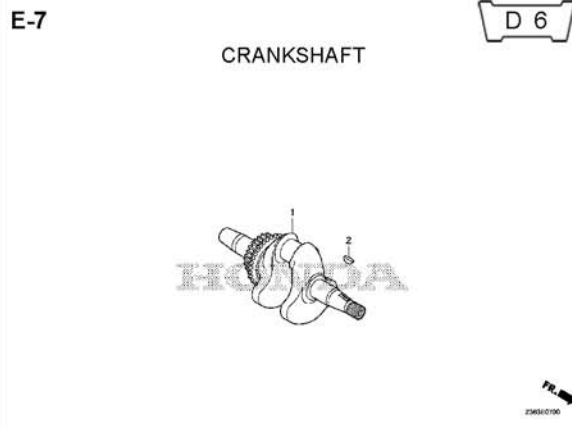
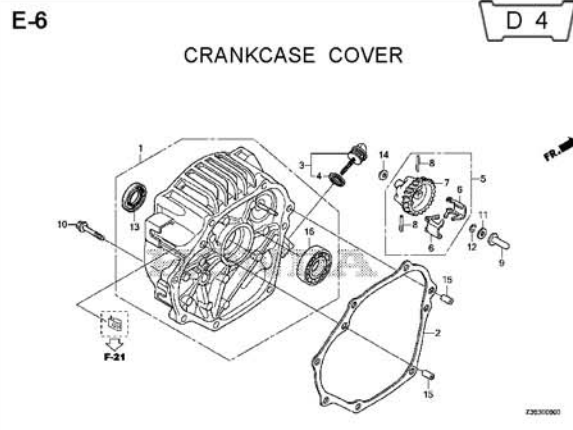
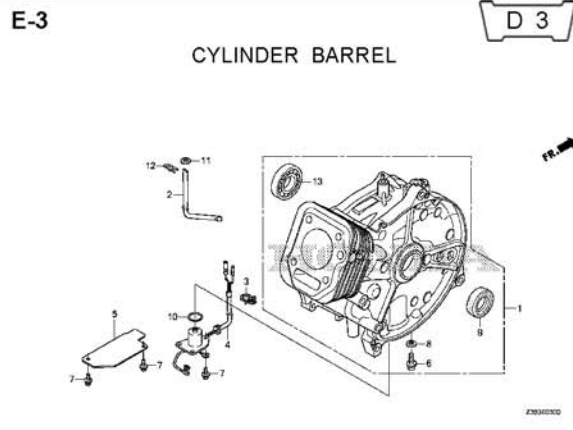
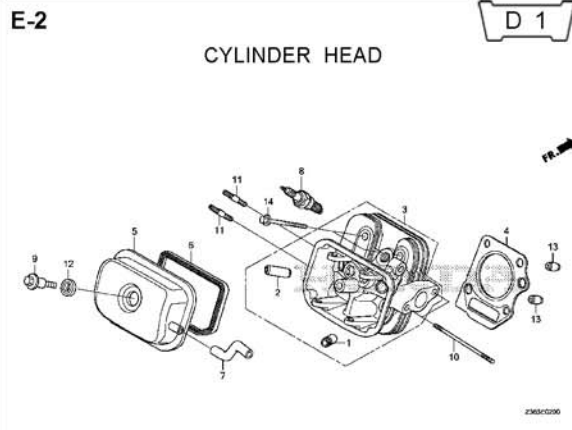

**2**

ENGINE GROUP

B15

E-19

FLYWHEEL

E 1

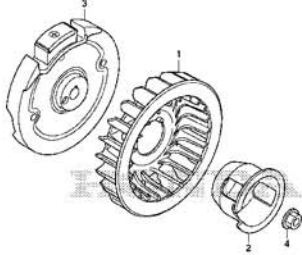

ZM01100

E-20

IGNITION COIL

E 2

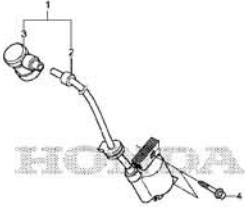

ZM02400

E-22

CONTROL

E 3

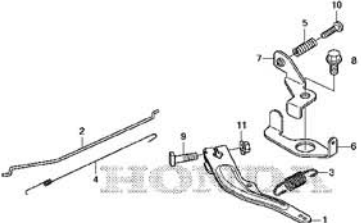

ZM03200

2

# FRAME GROUP

**B16**

F-2

CONTROL PANEL(1)

F 1

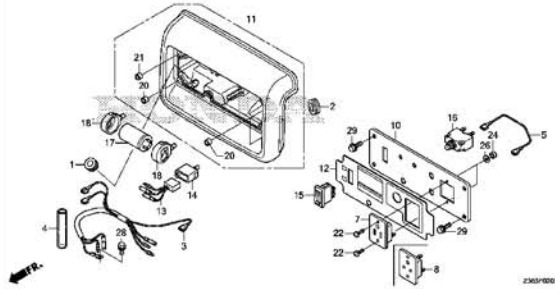

F-2-1

CONTROL PANEL(2)

F 3

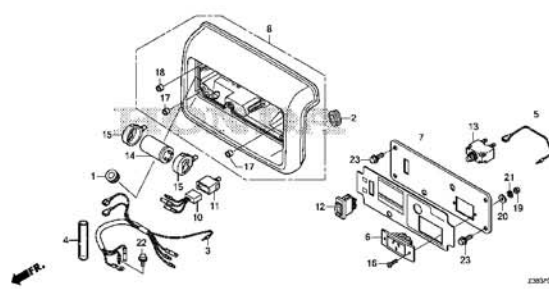

F-9

RECOIL STARTER

F 4

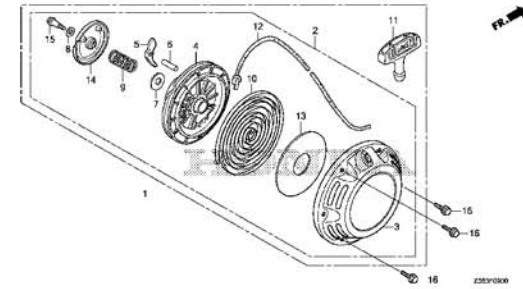

F-15

MUFFLER PROTECTOR

F 5

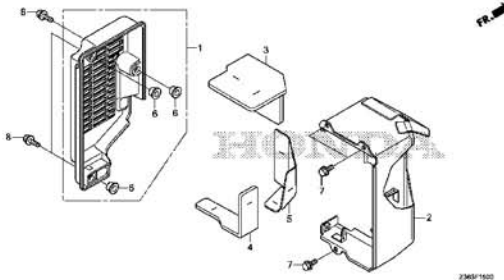

F-16

FUEL TANK

F 6

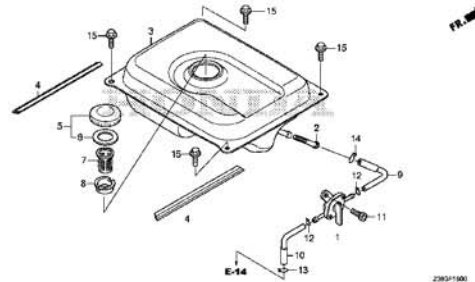

F-21

FAN COVER/SHROUD

F 7

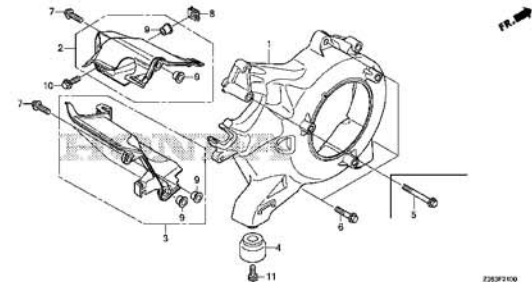

F-22

FRONT COVER/REAR COVER

F 8

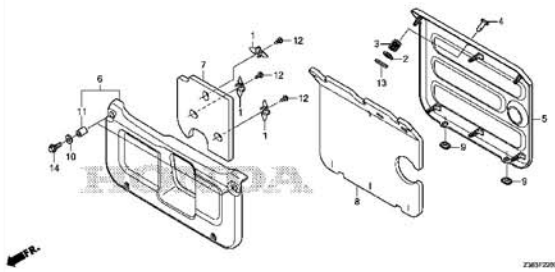

F-25

FRAME(EG1000N)

F 9

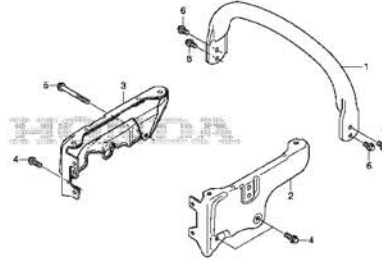

F-25-1

FRAME(EP1000N)

F10

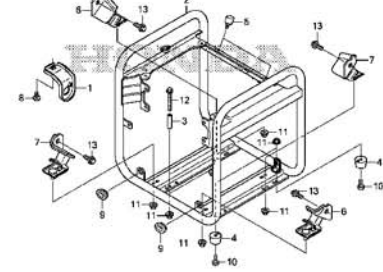

2

# FRAME GROUP

C 1

F-29

ROTOR/STATOR

F11

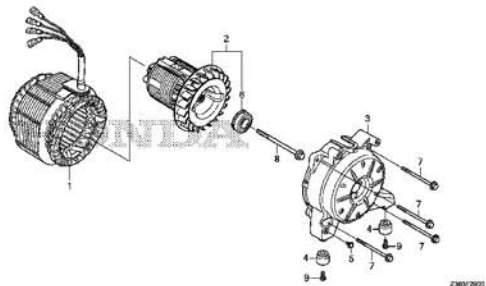

F-31

LABEL(EG1000N)

F12

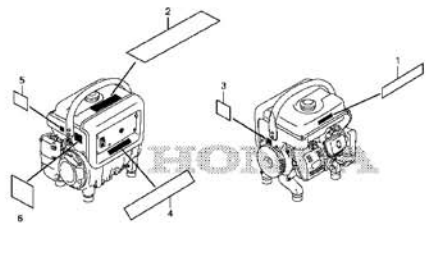

F-31-1

LABEL(EP1000N)

F13

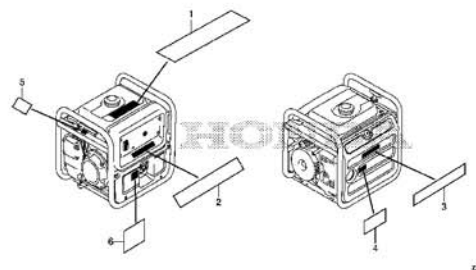

F-32

TOOL

F14

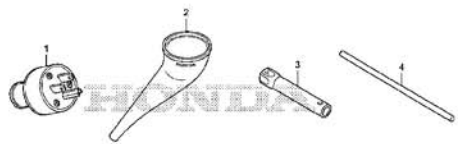

2

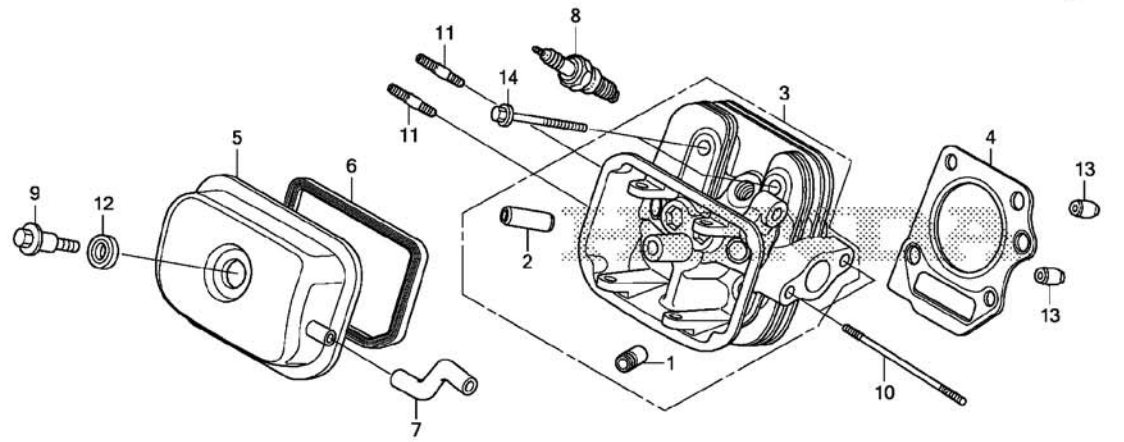

Z363E0200

Ref. No.	L.O.N.	(Relative ref. Number) Description	F.R.T.
1	1111E9	GUIDE, INTAKE VALVE ..... .INCLUDES: Engine removal and installation .INCLUDES: Valve clearance adjustment	1.9
	1111E9E	.Replace intake and exhaust all add .....	0.3
	1111BA	GUIDE, INTAKE VALVE(A) ..... .INCLUDES: Valve clearance adjustment .NOTE: EG model	1.4
	1111BAA	.Replace intake and exhaust all add .....	0.3
2	1111E8	GUIDE, EXHAUST VALVE ..... .INCLUDES: Engine removal and installation .INCLUDES: Valve clearance adjustment	1.9
	1111E8E	.Replace intake and exhaust all add .....	0.3
	1111BB	GUIDE, EXHAUST VALVE(A) ..... .INCLUDES: Valve clearance adjustment .NOTE: EG model	1.4

Ref. No.	Part No.	Description	Reqd. QTY		Serial No.	Parts catalogue code
			EG 1000 N	EP 1000 N		
1	12204-ZCJ-305	GUIDE, IN. VALVE(O.S.) .....	1	1		
2	12205-ZCJ-305	GUIDE, EX. VALVE(O.S.) .....	1	1		
3	12210-ZCJ-405	HEAD COMP., CYLINDER .....	1	1		
4	12251-ZCJ-003	GASKET, CYLINDER HEAD .....	1	1		
5	12310-ZCJ-000	COVER COMP., HEAD .....	1	1		
6	12312-ZCJ-000	PACKING, HEAD COVER .....	1	1		
7	15721-ZCJ-000	TUBE, BREATHER .....	1	1		
8	31914-Z8Y-003	PLUG, SPARK(LR4C-E)(NGK) .....	1	1		
9	90003-KFG-000	BOLT, L. CRANKCASE COVER .....	1	1		
10	90043-ZCJ-000	BOLT, STUD, 6X65(CT200) .....	2	2		
11	90045-892-000	BOLT, STUD, 6X28(CT200) .....	2	2		
12	90543-MV9-670	RUBBER, MOUNTING .....	1	1		
13	94301-08140	DOWEL PIN, 8X14 .....	2	2		
14	95701-06050-08	BOLT, FLANGE, 6X50 .....	4	4		

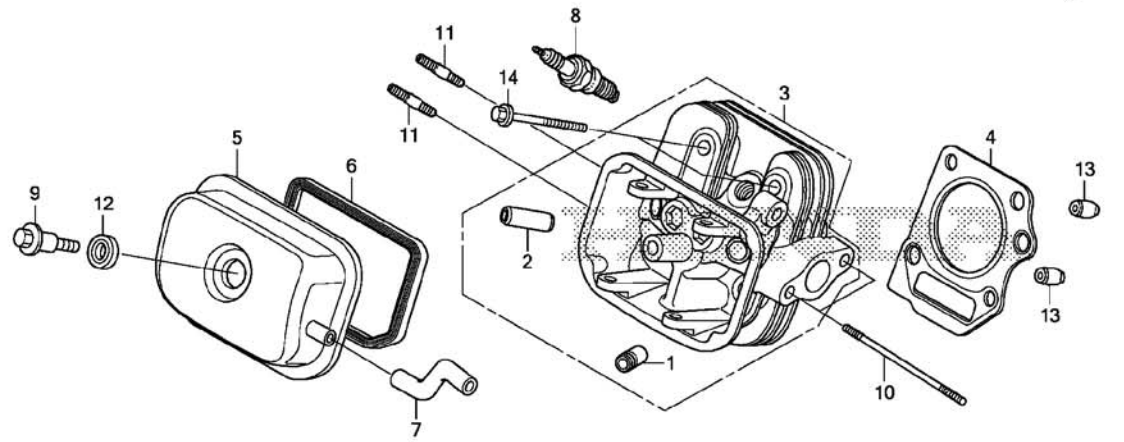

Z363E0200

Ref. No.	L.O.N.	(Relative ref. Number) Description	F.R.T.
+ 2	1111BBA	.Replace intake and exhaust all add .....	0.3
3	1111N3	HEAD, CYLINDER .....	2.1
		.INCLUDES: Engine removal and installation .INCLUDES: Valve clearance adjustment and reface	
	1111AZ	HEAD, CYLINDER(A) .....	1.6
		.INCLUDES: Valve clearance adjustment and reface .NOTE: EG model	
4	1111N4	GASKET, CYLINDER HEAD .....	1.6
		.INCLUDES: Engine removal and installation	
	1111BC	GASKET, CYLINDER HEAD(A) .....	1.1
		.NOTE: EG model (6)	
5	1111D5	CYLINDER HEAD COVER AND/OR PACKING .....	0.1
7	1111K5	TUBE, BREATHER .....	0.1
8	6141C1	PLUG, SPARK .....	0.1
		.INCLUDES: Spark plug check	



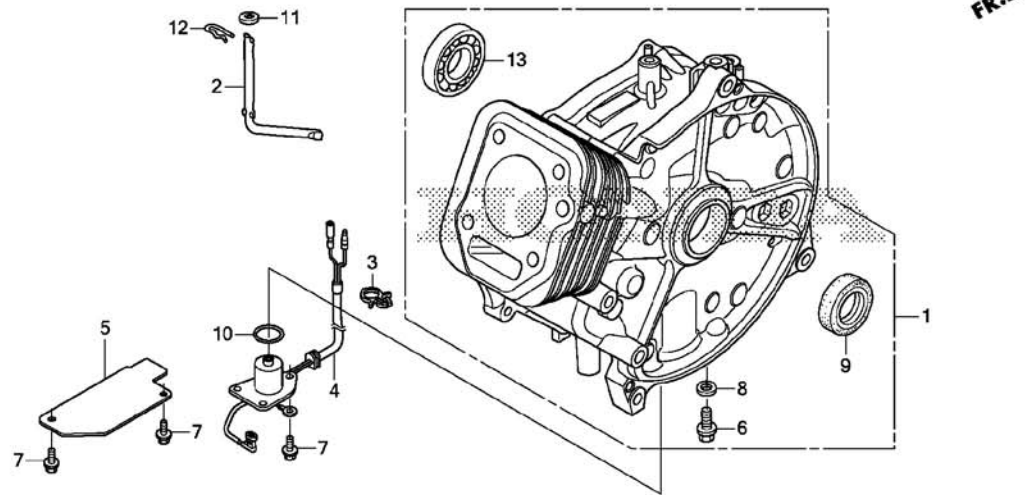

Z363E0300

Ref. No.	L.O.N.	(Relative ref. Number) Description	F.R.T.
1	1101A0	BARREL, CYLINDER ..... .INCLUDES: Engine removal and installation	2.5
	1101U5	BARREL, CYLINDER(A) ..... .NOTE: EG model	2.0
2	1161B4	SHAFT, GOVERNOR ARM ..... .INCLUDES: Engine removal and installation	1.4
	1161E2	SHAFT, GOVERNOR ARM(A) ..... .NOTE: EG model	0.9
4	6151E8	SWITCH, OIL LEVEL ..... (10)	0.6
9	1101E3	OIL SEAL, CRANKSHAFT :RIGHT .. .INCLUDES: Engine removal and installation	2.4
	1101U7	OIL SEAL, CRANKSHAFT(A) :RIGHT .NOTE: EG model	1.9
13	1101A7	BEARING, CRANKSHAFT :RIGHT ... .INCLUDES: Engine removal and installation	2.5
	1101V0	BEARING, CRANKSHAFT(A) :RIGHT .NOTE: EG model	2.0

Ref. No.	Part No.	Description	Reqd. QTY		Serial No.	Parts catalogue code
			EG 1000 N	EP 1000 N		
1	12000-ZCJ-405	BARREL ASSY., CYLINDER .....	1	1		
2	16541-ZDB-000	SHAFT, GOVERNOR ARM .....	1	1		
3	30701-883-000	CLIP, HIGH TENSION CORD(8MM)	1	1		
4	35480-ZCJ-003	SWITCH ASSY., OIL LEVEL .....	1	1		
5	35481-ZCJ-000	BRACKT, OIL LEVEL SWITCH .....	1	1		
6	90001-ZDA-000	BOLT, DRAIN PLUG, 10MM .....	1	1		
7	90012-896-750	BOLT, FLANGE, 5X14 .....	5	5		
8	90601-ZE1-000	WASHER, DRAIN PLUG, 10.2MM ..	1	1		
9	91202-892-003	OIL SEAL, 17X30X6(ARAI) .....	1	1		
10	91301-ZA8-004	O-RING, 34.6X2.5 .....	1	1		
11	94101-06800	WASHER, PLAIN, 6MM .....	1	1		
12	94251-08000	PIN, LOCK, 8MM .....	1	1		
13	96100-62030-00	BEARING, RADIAL BALL, 6203 ..	1	1		

E-6

CRANKCASE COVER

D 4

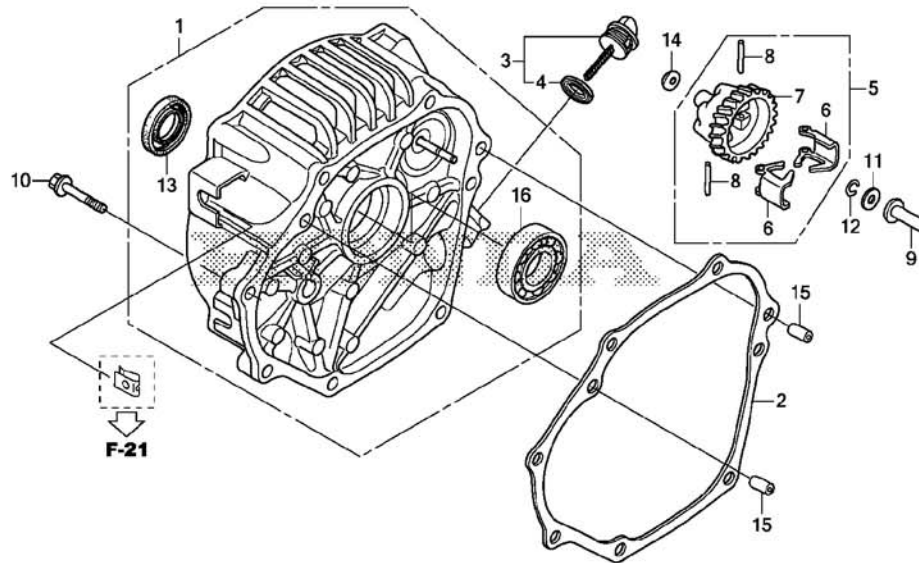

Ref. No.	L.O.N.	(Relative ref. Number) Description	F.R.T.
1	1101F1	COVER, CRANKCASE ..... .INCLUDES: Engine removal and installation	1.5
	1101G0	COVER, CRANKCASE(A) ..... .NOTE: EG model	1.0
2	1101E9	PACKING, CRANKCASE COVER ..... .INCLUDES: Engine removal and installation	1.4
	1101F9	PACKING, CRANKCASE COVER(A) .. .NOTE: EG model	0.9
5	1161C4	GOVERNOR ASSEMBLY ..... .INCLUDES: Engine removal and installation	1.5
	1161E9	GOVERNOR ASSEMBLY(A) ..... .NOTE: EG model	1.0
7	1161A7	HOLDER, GOVERNOR WEIGHT ..... .INCLUDES: Engine removal and installation	1.6
	1161C6	HOLDER, GOVERNOR WEIGHT(A) ... .NOTE: EG model	1.1
9	1161B6	SLIDER, GOVERNOR ..... .INCLUDES: Engine removal and installation	1.5
+	1161C7	SLIDER, GOVERNOR(A) ..... .NOTE: EG model	1.0

Ref. No.	Part No.	Description	Reqd. QTY		Serial No.	Parts catalogue code
			EG 1000 N	EP 1000 N		
1	11310-ZCJ-000	COVER COMP., CRANKCASE .....	1	1		
2	11381-ZCJ-000	PACKING, CASE COVER .....	1	1		
3	15600-ZCJ-010	CAP ASSY., OIL FILLER .....	1	1		
4	15625-ZOT-800	PACKING, OIL FILLER CAP .....	1	1		
5	16510-ZCJ-000	GOVERNOR ASSY. ....	1	1		
6	16511-ZCJ-000	WEIGHT, GOVERNOR .....	2	2		
7	16512-ZDA-000	HOLDER, GOVERNOR WEIGHT .....	1	1		
8	16513-ZDA-000	PIN, GOVERNOR WEIGHT .....	2	2		
9	16531-ZDB-000	SLIDER, GOVERNOR .....	1	1		
10	90015-883-000	BOLT, FLANGE, 6X28(CT200) ...	7	7		
11	90451-ZDA-000	WASHER, THRUST, 6MM .....	1	1		
12	90602-ZE1-000	CLIP, GOVERNOR HOLDER .....	1	1		
13	91202-892-003	OIL SEAL, 17X30X6(ARAI) .....	1	1		
14	94101-06800	WASHER, PLAIN, 6MM .....	1	1		
15	94301-08140	DOWEL PIN, 8X14 .....	2	2		
16	96100-62030-00	BEARING, RADIAL BALL, 6203 ..	1	1		

2

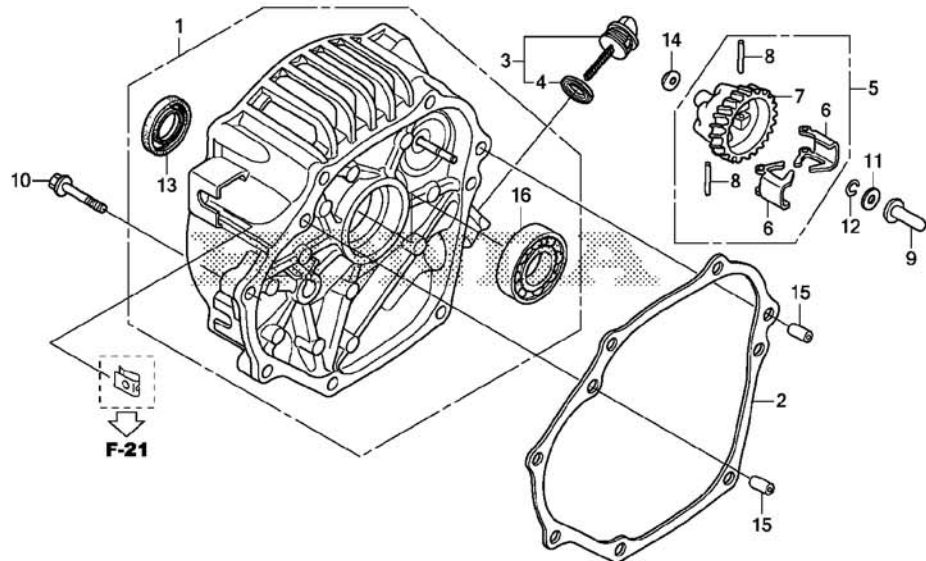

Z363E0600

Ref. No.	L.O.N.	(Relative ref. Number) Description	F.R.T.
+ 9		.NOTE: EG model	
13	1101C0	OIL SEAL, CRANKSHAFT :LEFT ... .INCLUDES: Engine removal and installation	1.5
	1101R8	OIL SEAL, CRANKSHAFT(A) :LEFT	1.0
16	1101A5	BEARING, CRANKSHAFT :LEFT .... .INCLUDES: Engine removal and installation	1.6
	1101R9	BEARING, CRANKSHAFT(A) :LEFT . .NOTE: EG model	1.1

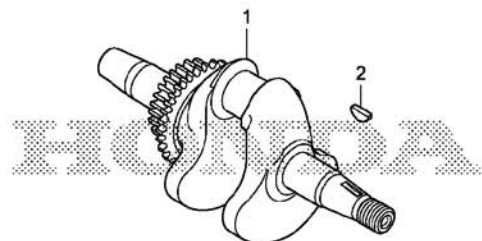

Ref. No.	L.O.N.	(Relative ref. Number) Description	F.R.T.
1	1101F0	CRANKSHAFT ..... .INCLUDES: Engine removal and installation	2.4
	1101U9	CRANKSHAFT(A) ..... .NOTE: EG model	1.9

Ref. No.	Part No.	Description	Reqd. QTY		Serial No.	Parts catalogue code
			EG 1000 N	EP 1000 N		
1	13310-ZCJ-000	CRANKSHAFT COMP. ....	1	-		
	13310-ZCJ-800	.....	-	1		
2	90741-147-000	KEY, WOODRUFF .....	1	1		



2

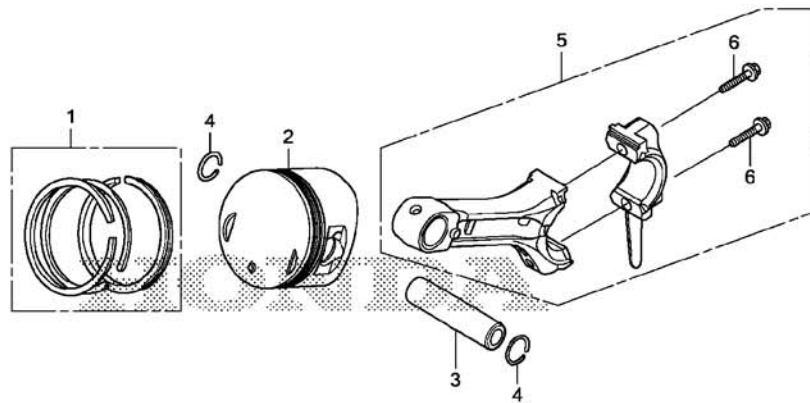

Z363E0800

Ref. No.	L.O.N.	(Relative ref. Number) Description	F.R.T.
2		(1,3,5)	
1111R1		PISTON AND/OR RING SET AND/OR BEARING AND/OR ROD ..... .INCLUDES: Engine removal and installation .INCLUDES: Inspection/Measurement/Cleaning	2.5
1111BJ		PISTON AND/OR RING SET AND/OR BEARING AND/OR ROD(A) ..... .INCLUDES: Inspection/Measurement/Cleaning .NOTE: EG model	2.0

Ref. No.	Part No.	Description	Reqd. QTY		Serial No.	Parts catalogue code
			EG 1000 N	EP 1000 N		
1	13010-ZCJ-004	RING SET, PISTON(STD.) (TPR) -	1	1		
	13010-ZCJ-005	RING SET, PISTON(STD.) (SAMKRG)	1	1		
	13011-ZCJ-004	RING SET, PISTON(0.25) (TPR) -	(1)	(1)		
	13011-ZCJ-005	RING SET, PISTON(0.25) (SAMKRG)	(1)	(1)		
	13012-ZCJ-004	RING SET, PISTON(0.50) (TPR) -	(1)	(1)		
	13012-ZCJ-005	RING SET, PISTON(0.50) (SAMKRG)	(1)	(1)		
2	13101-ZCJ-000	PISTON(STD.) .....	1	1		
	13102-ZCJ-000	PISTON(0.25) .....	(1)	(1)		
	13103-ZCJ-000	PISTON(0.50) .....	(1)	(1)		
3	13111-ZCJ-000	PIN, PISTON .....	1	1		
4	13115-ZCJ-000	CLIP, PISTON PIN, 12MM .....	2	2		
5	13200-ZCJ-000	ROD ASSY., CONNECTING .....	1	1		
	13200-ZCJ-305	ROD ASSY., CONNECTING (UNDER SIZE)	(1)	(1)		
6	90001-ZCJ-000	BOLT, CONNECTING ROD .....	2	2		

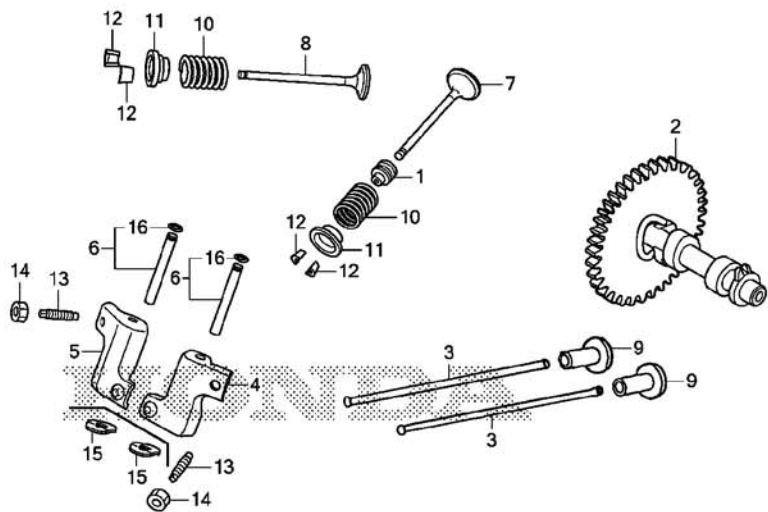

Z363E0900

Ref. No.	L.O.N.	(Relative ref. Number) Description	F.R.T.
1	1111K2	SEAL, INTAKE VALVE STEM ..... .INCLUDES: Engine removal and installation .INCLUDES: Valve clearance adjustment	1.6
	1111BH	SEAL, INTAKE VALVE STEM(A) ... .INCLUDES: Valve clearance adjustment .NOTE: EG model	1.1
2	1111C2	CAMSHAFT ..... .INCLUDES: Engine removal and installation .INCLUDES: Valve clearance adjustment	2.3
	1111BM	CAMSHAFT(A) ..... .INCLUDES: Valve clearance adjustment .NOTE: EG model	1.8
3	1111L6	ROD, PUSH :INTAKE ..... .INCLUDES: Valve clearance adjustment	0.2
	1111L7	ROD, PUSH :EXHAUST ..... .INCLUDES: Valve clearance adjustment	0.2
+	1111L8	ROD, PUSH :BOTH ..... .INCLUDES: Valve clearance adjustment	0.3



Ref. No.	Part No.	Description	Reqd. QTY		Serial No.	Parts catalogue code
			EG 1000 N	EP 1000 N		
1	12209-GB4-682	SEAL, VALVE STEM(ARAI) .....	1	1		
2	14100-ZCJ-000	CAMSHAFT ASSY. ....	1	-		
	14100-ZCJ-800	.....	-	1		
3	14410-ZCJ-000	ROD COMP., PUSH .....	2	-		
	14410-ZCJ-800	.....	-	2		
4	14431-ZCJ-000	ARM, IN. VALVE ROCKER .....	1	1		
5	14441-ZCJ-000	ARM, EX. VALVE ROCKER .....	1	1		
6	14460-ZCJ-000	SHAFT COMP., ROCKER ARM .....	2	2		
7	14711-ZCJ-000	VALVE, IN. ....	1	1		
8	14721-ZCJ-000	VALVE, EX. ....	1	1		
9	14731-ZCJ-000	LIFTER, VALVE .....	2	2		
10	14751-ZCJ-000	SPRING, VALVE .....	2	2		
11	14771-ZCJ-000	RETAINER, VALVE SPRING .....	2	2		
12	14781-MA6-000	COTTER, VALVE .....	4	4		
13	90012-ZCJ-000	SCREW, TAPPET ADJUSTING .....	2	2		
14	90206-ZCJ-000	NUT, TAPPET ADJUSTING .....	2	2		
15	90401-ZCJ-800	WASHER, WAVE, 18X7 .....	-	2		
16	90602-ZE1-000	CLIP, GOVERNOR HOLDER .....	2	2		

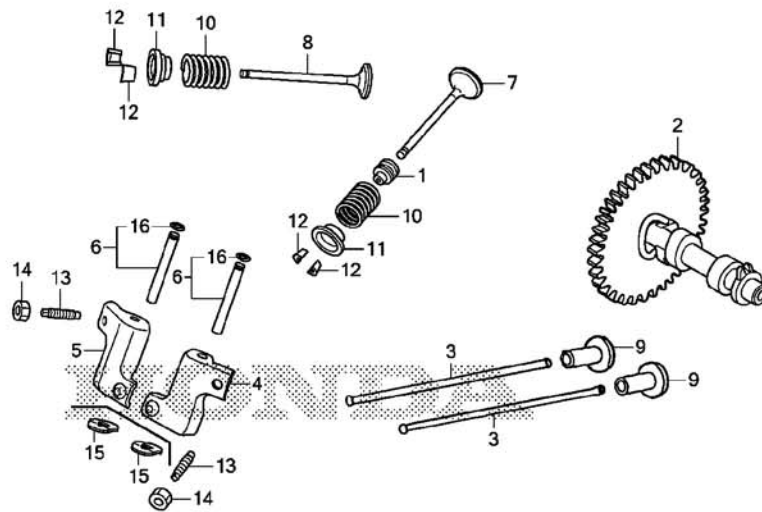

Z363E0900

Ref. No.	L.O.N.	(Relative ref. Number) Description	F.R.T.
+ 3		.INCLUDES: Valve clearance adjustment	
4	1111A2	ARM, ROCKER :INTAKE .....	0.2
		.INCLUDES: Valve clearance adjustment	
	1111A2A	.Replace exhaust rocker arm add .....	0.1
5	1111A1	ARM, ROCKER :EXHAUST .....	0.2
		.INCLUDES: Valve clearance adjustment	
	1111A1A	.Replace intake rocker arm add	0.1
7	1111L1	VALVE, INTAKE .....	1.7
		.INCLUDES: Engine removal and installation	
	1111L1E	.INCLUDES: Valve clearance adjustment and reface .Replace intake and exhaust all add .....	0.2
	1111BD	VALVE, INTAKE(A) .....	1.2
		.INCLUDES: Valve clearance adjustment and reface .NOTE: EG model	
	1111BDA	.Replace intake and exhaust all add .....	0.2
+ 8	1111L0	VALVE, EXHAUST .....	1.7

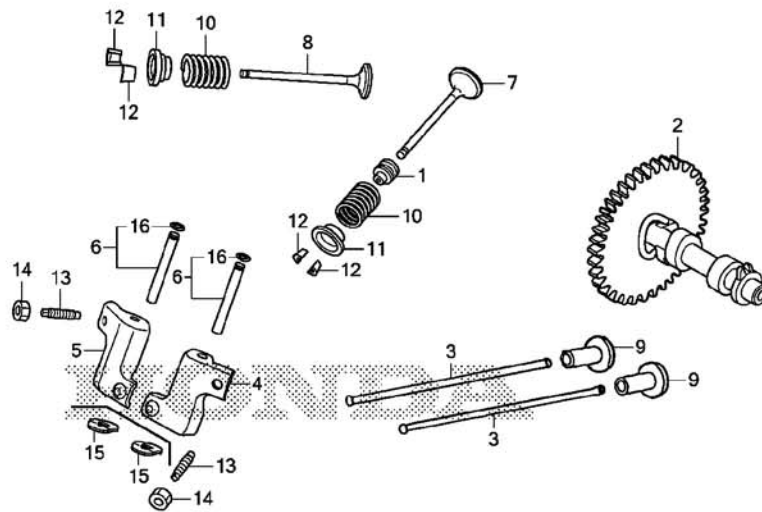

Z363E0900

Ref. No.	L.O.N.	(Relative ref. Number) Description	F.R.T.
+ 8		.INCLUDES: Engine removal and installation .INCLUDES: Valve clearance adjustment and reface	
1111LOE		.Replace intake and exhaust all add .....	0.2
1111BE		VALVE, EXHAUST(A) .....	1.2
		.INCLUDES: Valve clearance adjustment and reface .NOTE: EG model	
1111BEA		.Replace intake and exhaust all add .....	0.2
9 1111L9		LIFTER, VALVE :INTAKE .....	2.3
		.INCLUDES: Engine removal and installation .INCLUDES: Valve clearance adjustment	
1111MD		LIFTER, VALVE :EXHAUST .....	2.3
		.INCLUDES: Engine removal and installation .INCLUDES: Valve clearance adjustment	
1111M1		LIFTER, VALVE :BOTH .....	2.3
		.INCLUDES: Engine removal and installation	
+			



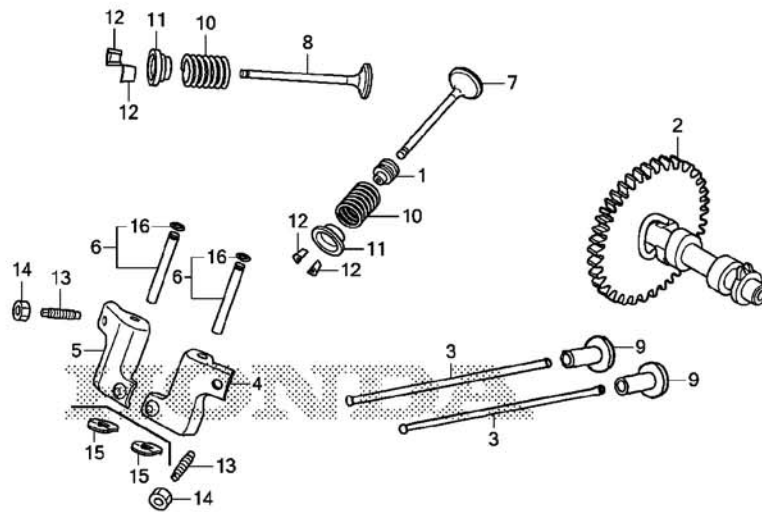

Z363E0900

Ref. No.	L.O.N.	(Relative ref. Number) Description	F.R.T.
+ 9		.INCLUDES: Valve clearance adjustment	
1111BL		LIFTER, VALVE(A) :EXHAUST ....	1.8
		.INCLUDES: Valve clearance adjustment	
1111BK		.NOTE: EG model LIFTER, VALVE(A) :INTAKE .....	1.8
		.INCLUDES: Valve clearance adjustment	
1111BX		.NOTE: EG model LIFTER, VALVE(A) :BOTH .....	1.8
		.INCLUDES: Valve clearance adjustment	
10 1111P3		.NOTE: EG model SPRING, VALVE :INTAKE .....	1.6
		.INCLUDES: Engine removal and installation	
		.INCLUDES: Valve clearance adjustment	
1111P3A		.Replace intake and exhaust all add .....	0.1
1111P4		SPRING, VALVE :EXHAUST .....	1.6
		.INCLUDES: Engine removal and installation	
+			

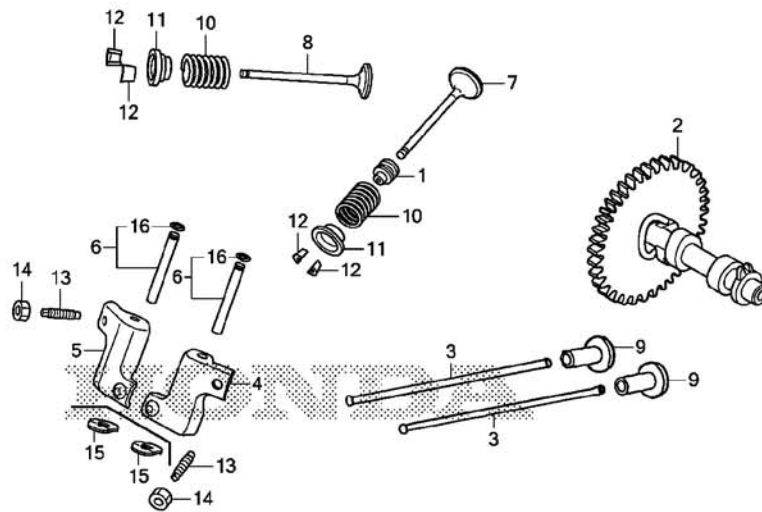

Z363E0900

Ref. No.	L.O.N.	(Relative ref. Number) Description	F.R.T.
+10		.INCLUDES: Valve clearance adjustment	
1111P4A		.Replace intake and exhaust all add .....	0.1
1111BF		SPRING, VALVE(A) :INTAKE .....	1.1
		.INCLUDES: Valve clearance adjustment	
		.NOTE: EG model	
1111BFA		.Replace intake and exhaust all add .....	0.1
1111BG		SPRING, VALVE(A) :EXHAUST ....	1.1
		.INCLUDES: Valve clearance adjustment	
		.NOTE: EG model	
1111BGA		.Replace intake and exhaust all add .....	0.1



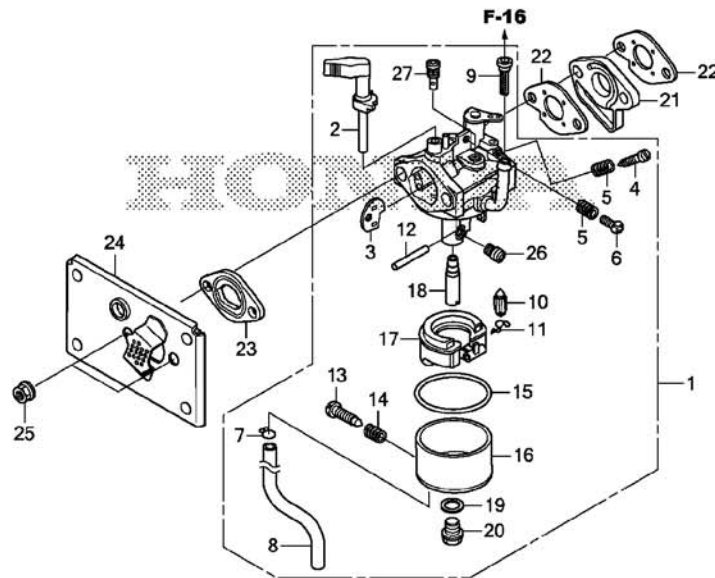

Ref. No.	L.O.N.	(Relative ref. Number) Description	F.R.T.
1	3111F3	CARBURETOR .....	0.5
2	(3)		
10	8101F9	LEVER, CARBURETOR CHOKE .....	0.6
	(17)		
	3111E1	FLOAT VALVE SET AND/OR FLOAT SET .....	0.6
16	3111A3	FLOAT CHAMBER SET AND/OR GASKET .....	0.5
18	3111Y7	NOZZLE, MAIN .....	0.7
21	3111C0	CARBURETOR INSULATOR AND/OR PACKING .....	0.5
22	3111C8	PACKING, CARBURETOR .....	0.5
		.NOTE: Same time for two units	
23	3121D9	PACKING, AIR CLEANER .....	0.2
24	3121Q0	BASE, AIR CLEANER .....	0.2
26	3111C3	JET, MAIN .....	0.6

Z363E1400

Ref. No.	Part No.	Description	Reqd. QTY		Serial No.	Parts catalogue code
			EG 1000 N	EP 1000 N		
1	16100-ZCJ-003	CARBURETOR ASSY. (ZCJA-0034) ..	1	1		
2	16101-ZCJ-003	SHAFT, CHOKE .....	1	1		
3	16102-ZCJ-003	VALVE, CHOKE .....	1	1		
4	16103-ZCJ-003	SCREW, PILOT .....	1	1		
5	16104-ZCJ-003	SPRING .....	2	2		
6	16105-ZCJ-003	SCREW(SRA) .....	1	1		
7	16106-ZCJ-003	CLIP, TUBE(DRAIN) .....	1	1		
8	16107-ZCJ-003	TUBE(DRAIN) .....	1	1		
9	16108-ZCJ-003	FILTER(INLET) .....	1	1		
10	16109-ZCJ-003	NEEDLE ASSY. ....	1	1		
11	16110-ZCJ-003	CLIP .....	1	1		
12	16111-ZCJ-003	PIN, FLOAT .....	1	1		
13	16112-ZCJ-003	SCREW .....	1	1		
14	16113-ZCJ-003	SPRING .....	1	1		
15	16114-ZCJ-003	O-RING .....	1	1		
16	16115-ZCJ-003	BODY, FLOAT CHAMBER .....	1	1		
17	16116-ZCJ-003	FLOAT SET .....	1	1		
18	16117-ZCJ-003	NOZZLE, MAIN .....	1	1		
19	16118-ZCJ-003	WASHER .....	1	1		
20	16119-ZCJ-003	SCREW .....	1	1		
21	16211-ZCJ-000	INSULATOR, CARBURETOR .....	1	1		
22	16212-ZCJ-000	PACKING, INSULATOR .....	2	2		
23	16269-ZA8-010	GASKET, AIR CLEANER .....	1	1		
24	17222-ZCJ-000	BASE, AIR CLEANER .....	1	1		
25	94050-06080	NUT, FLANGE, 6MM .....	2	2		

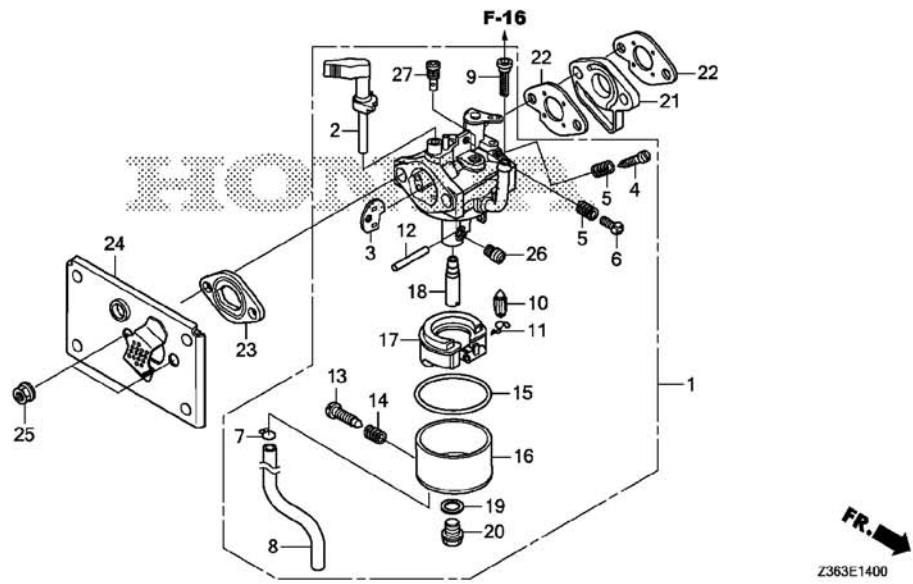

Ref. No.	Part No.	Description	Reqd. QTY		Serial No.	Parts catalogue code
			EG 1000 N	EP 1000 N		
26	99131-ZCJ-0500	JET, MAIN, #50 .....	(1)	(1)		
	99131-ZCJ-0520	JET, MAIN, #52.5 .....	(1)	(1)		
	99131-ZCJ-0550	JET, MAIN, #55 .....	1	1		
27	99133-ZCJ-0320	JET, PILOT, #32.5 .....	1	1		

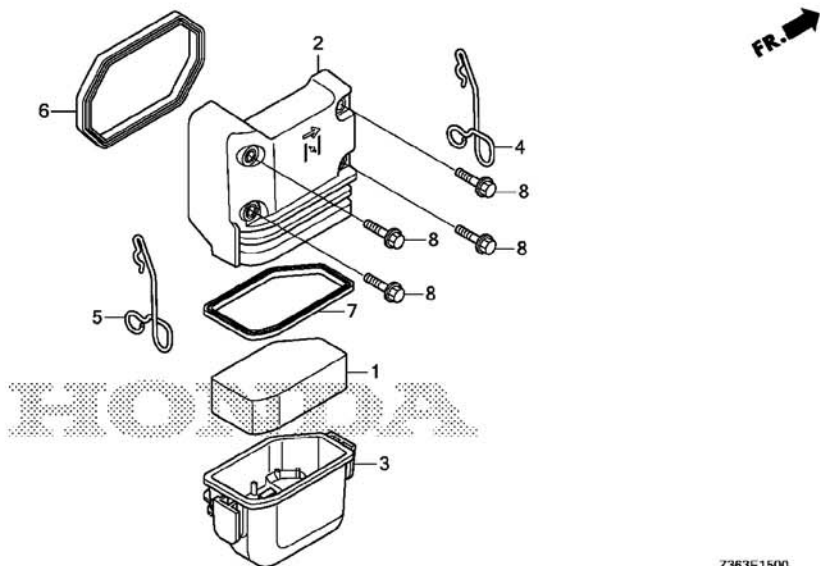

Z363E1500

Ref. No.	L.O.N.	(Relative ref. Number) Description	F.R.T.
1	3121B8	ELEMENT, AIR CLEANER ..... .INCLUDES: Air cleaner element -inspection	0.1
2	3121A5	CASE, AIR CLEANER .....	0.2
6	3121E8	SEAL, AIR CLEANER CASE .....	0.1
7	3121E9	SEAL, AIR CLEANER COVER .....	0.1

Ref. No.	Part No.	Description	Reqd. QTY		Serial No.	Parts catalogue code
			EG 1000 N	EP 1000 N		
1	17211-ZCJ-000	ELEMENT, AIR CLEANER .....	1	1		
2	17220-ZCJ-000	CASE COMP., AIR CLEANER .....	1	1		
3	17223-ZCJ-000	CASE COMP., AIR CLEANER ELEMENT	1	1		
4	17226-ZCO-000	SPRING, R. AIR CLEANER CASE ..	1	1		
5	17247-ZCJ-000	SPRING, L. AIR CLEANER CASE ..	1	-		
	17227-ZCO-000	.....	-	1		
6	17227-ZCJ-000	RUBBER, AIR CLEANER CASE ....	1	1		
7	17229-ZCJ-000	PACKING, AIR CLEANER CASE ...	1	1		
8	95701-06028-07	BOLT, FLANGE, 6X28 .....	4	4		

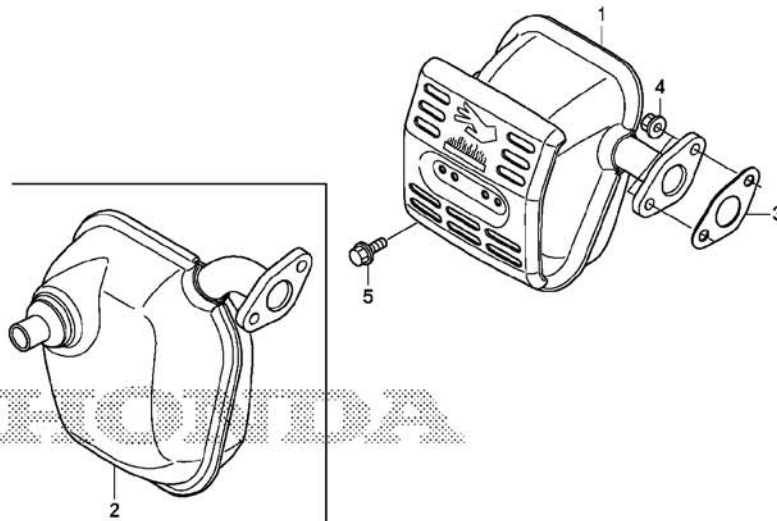

Z363E1600

Ref. No.	L.O.N.	(Relative ref. Number) Description	F.R.T.
1		(2)	
3131C5		MUFFLER, EXHAUST .....	0.2
3131B4		GASKET, EXHAUST MUFFLER .....	0.2

Ref. No.	Part No.	Description	Reqd. QTY		Serial No.	Parts catalogue code
			EG 1000 N	EP 1000 N		
1	18310-ZCJ-000	MUFFLER COMP. ....	1	-		
2	18310-ZCJ-900	MUFFLER COMP. ....	-	1		
3	18381-ZCJ-000	GASKET, MUFFLER .....	1	1		
4	94050-06080	NUT, FLANGE, 6MM .....	2	2		
5	95701-06012-08	BOLT, FLANGE, 6X12 .....	1	1		



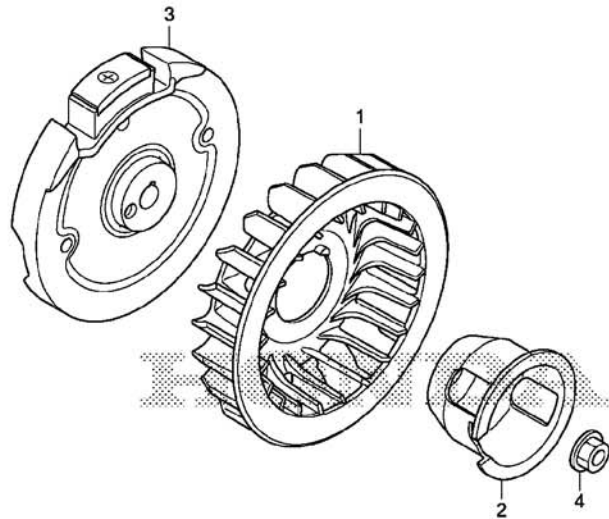

Z363E1900

Ref. No.	L.O.N.	(Relative ref. Number) Description	F.R.T.
1	1141G7	FAN, ENGINE COOLING ..... .INCLUDES: Engine removal and installation	1.3
	1141J0	FAN, ENGINE COOLING(A) ..... .NOTE: EG model	0.8
2	1121A9	PULLEY, RECOIL STARTER ..... .INCLUDES: Engine removal and installation	1.3
	1121F4	PULLEY, RECOIL STARTER(A) .... .NOTE: EG model	0.8
3	2161B5	FLYWHEEL ..... .INCLUDES: Engine removal and installation	1.5
	2161Q5	FLYWHEEL(A) ..... .NOTE: EG model	1.0

Ref. No.	Part No.	Description	Reqd. QTY		Serial No.	Parts catalogue code
			EG 1000 N	EP 1000 N		
1	19511-ZCJ-000	FAN, COOLING .....	1	1		
2	28451-ZCJ-000	PULLEY, STARTER .....	1	1		
3	31110-ZCJ-000	FLYWHEEL COMP. ....	1	1		
4	94050-12080	NUT, FLANGE, 12MM .....	1	1		

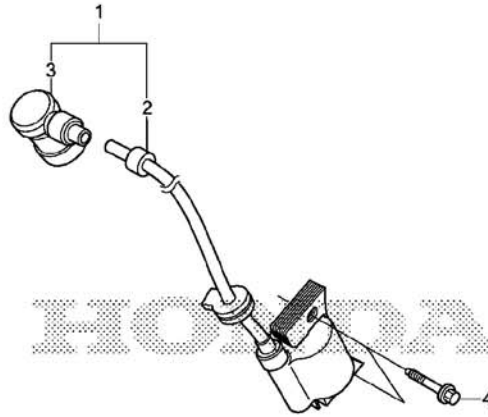

Z363E2000

Ref. No.	L.O.N.	(Relative ref. Number) Description	F.R.T.
1		(2)	
6141A5		COIL, IGNITION(ONE) ..... .INCLUDES: Engine removal and installation	1.4
6141D2		COIL, IGNITION(A) ..... .NOTE: EG model	0.9

Ref. No.	Part No.	Description	Reqd. QTY		Serial No.	Parts catalogue code
			EG 1000 N	EP 1000 N		
1	30500-ZCJ-003	COIL ASSY., IGNITION .....	1	1	-----	K,L,LS,R,RA,RDN,S
2	30500-ZCJ-831	COIL ASSY., IGNITION .....	1	-	-----	M
3	30700-ZCJ-003	TERMINAL ASSY., HIGH TENSION	1	1	-----	K,L,LS,R,RA,RDN,S
	30700-ZCJ-831	CAP ASSY., NOISE SUPPRESSOR .	1	-	-----	M
4	90121-952-000	BOLT, FLANGE, 6X25(CT200) ...	2	2		



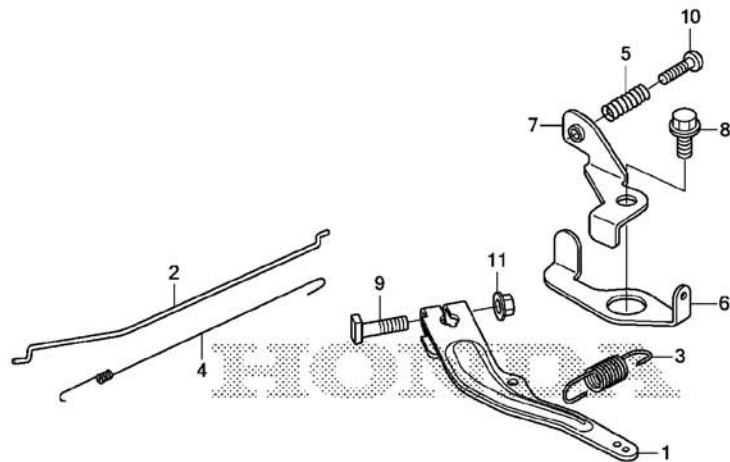

Z363E2200

Ref. No.	L.O.N.	(Relative ref. Number) Description	F.R.T.
1	1161A0	ARM, GOVERNOR .....	0.5
2	1161B1	ROD, GOVERNOR .....	0.5
3	1161C5	SPRING, GOVERNOR .....	0.5
4	1161C2	SPRING, THROTTLE RETURN .....	0.5
6	1161A8	LEVER, CONTROL .....	0.5

Ref. No.	Part No.	Description	Reqd. QTY		Serial No.	Parts catalogue code
			EG 1000 N	EP 1000 N		
1	16551-ZCJ-000	ARM, GOVERNOR .....	1	1		
2	16555-ZCJ-000	ROD, GOVERNOR .....	1	1		
3	16561-ZCJ-000	SPRING, GOVERNOR .....	1	1	----- K,M,R,RA,RDN	
	16561-ZCJ-820	.....	1	-	----- L,LS,S	
4	16562-ZCJ-000	SPRING, THROTTLE RETURN .....	1	1		
5	16571-836-000	SPRING, CONTROL ADJUSTING .....	1	1		
6	16571-ZCJ-000	LEVER, CONTROL .....	1	-		
	16571-ZCJ-800	.....	-	1		
7	16581-ZCJ-000	BASE, CONTROL .....	1	-		
	16581-ZCJ-800	.....	-	1		
8	90013-883-000	BOLT, FLANGE, 6X12(CT200) .....	1	1		
9	90015-ZE5-010	BOLT, GOVERNOR ARM .....	1	1		
10	93500-04016-OH	SCREW, PAN, 4X16 .....	1	1		
11	94050-06080	NUT, FLANGE, 6MM .....	1	1		

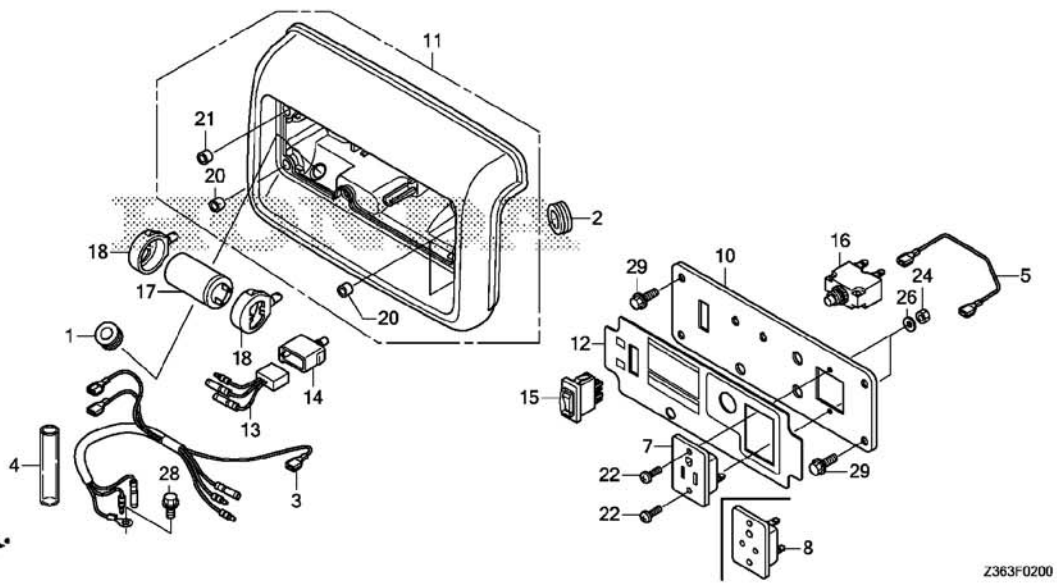

Ref. No.	L.O.N.	(Relative ref. Number) Description	F.R.T.
3	6111B9	HARNES, CONTROL WIRE .....	0.3
5	6111F1	CORD, TERMINAL .....	0.2
7		(8)	
	6221D5	RECEPTACLE/CONSENT, CONTROL PANEL .....	0.2
10	6221N9	PANEL, GENERATOR CONTROL .....	0.3
11	4131M5	CASE, CONTROL .....	0.3
12	6221C5	MARK, CONTROL PANEL .....	0.3
13	6151A0	ALERT UNIT, ENGINE OIL .....	0.3
15	6151D9	SWITCH, ENGINE STOP .....	0.2
16	6221D4	PROTECTOR, CIRCUIT .....	0.2
17	6221J9	CONDENSER, CONTROL BOX .....	0.3

Ref. No.	Part No.	Description	Reqd. QTY		Serial No.	Parts catalogue code
			EG 1000 N	EP 1000 N		
1	31472-Z36-D60	GROMMET, CONTROL HARNESS .....	1	1	-----	K,L,LS,M,R,RDN,S
2	31473-ZR3-S40	GROMMET, UNIT SWITCH .....	1	1	-----	K,L,LS,M,R,RDN,S
3	32150-Z36-D60	HARNES ASSY., CONTROL WIRE .....	1	-	-----	K,LS,M,R,S
	32150-Z36-D30	.....	1	-	-----	L
	32150-Z36-R00	.....	-	1	-----	
4	32151-Z36-D60	TUBE, CONTROL HARNESS .....	1	1	-----	K,L,LS,M,R,RDN,S
5	32221-Z36-D60	CORD, TERMINAL .....	1	1	-----	K,LS,M,R,RDN,S
	32221-Z36-D30	.....	1	-	-----	L
7	32330-Z36-D61	RECEPTACLE(15A/250V) .....	1	1	-----	K,L,LS,M,R,S
8	32330-Z36-R01	RECEPTACLE(6A/240V) .....	-	1	-----	RDN
10	32345-Z36-D60	PANEL, CONTROL .....	1	1	-----	K,L,LS,M,R,RDN,S
11	32350-Z36-D60ZA	CASE COMP., CONTROL PANEL *R280*.....POWER RED	1	1	-----	K,L,LS,M,R,RDN,S
12	32366-Z36-D30	MARK, CONTROL PANEL .....	1	-	-----	L
	32366-Z36-R70	.....	1	-	-----	LS
	32366-Z36-D60	.....	1	-	-----	M,R
	32366-Z36-C70	.....	1	-	-----	S
	32366-Z36-R60	.....	-	1	-----	R
	32366-Z36-R00	.....	-	1	-----	RDN
13	34150-Z36-D61	ALERT UNIT, OIL .....	1	1	-----	K,L,LS,M,R,RDN,S
14	34152-Z36-D60	CUSHION, OIL ALERT UNIT .....	1	1	-----	K,L,LS,M,R,RDN,S
15	35120-Z36-D61	SWITCH ASSY., ENGINE STOP(RED)	1	1	-----	K,L,LS,M,R,RDN,S
16	38240-Z36-D61	PROTECTOR, CIRCUIT(4.0A) .....	1	1	-----	K,M,R,RDN
	38240-Z36-D31	PROTECTOR, CIRCUIT(9.0A) .....	1	-	-----	L
	38240-Z36-C71	PROTECTOR, CIRCUIT(5.0A) .....	1	-	-----	LS,S
17	38386-ZR9-S50	CONDENSER .....	1	1	-----	K,L,LS,M,R,RDN,S

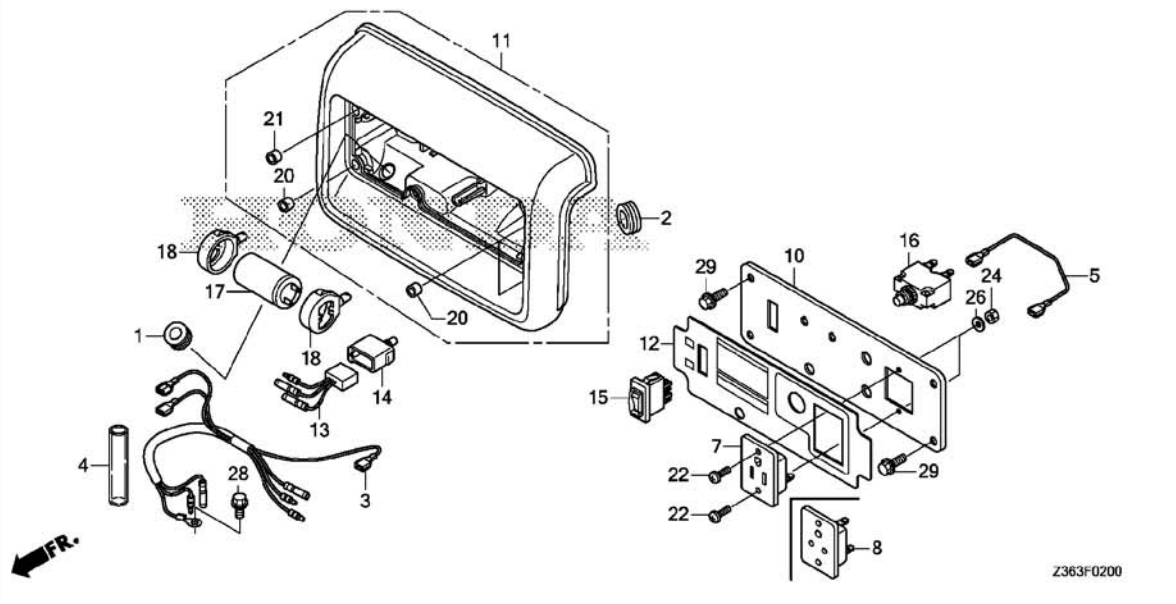

Ref. No.	Part No.	Description	Reqd. QTY		Serial No.	Parts catalogue code
			EG 1000 N	EP 1000 N		
18	38387-Z36-D60	CUSHION, CAPACITOR .....	2	2	-----	K,L,LS,M,R,RDN,S
20	91551-Z15-000	COLLAR, CONTROL CASE .....	3	3	-----	K,L,LS,M,R,RDN,S
21	91555-Z36-D60	COLLAR, CONTROL CASE .....	1	1	-----	K,L,LS,M,R,RDN,S
22	93500-04012-1G	SCREW, PAN, 4X12 .....	2	2	-----	K,L,LS,M,R,RDN,S
24	94001-04080-0S	NUT, HEX., 4MM .....	2	2	-----	K,L,LS,M,R,RDN,S
26	94101-04800	WASHER, PLAIN, 4MM .....	2	2	-----	K,L,LS,M,R,RDN,S
28	95701-06012-08	BOLT, FLANGE, 6X12 .....	1	1	-----	K,L,LS,M,R,RDN,S
29	95701-06018-07	BOLT, FLANGE, 6X18 .....	4	4	-----	K,L,LS,M,R,RDN,S

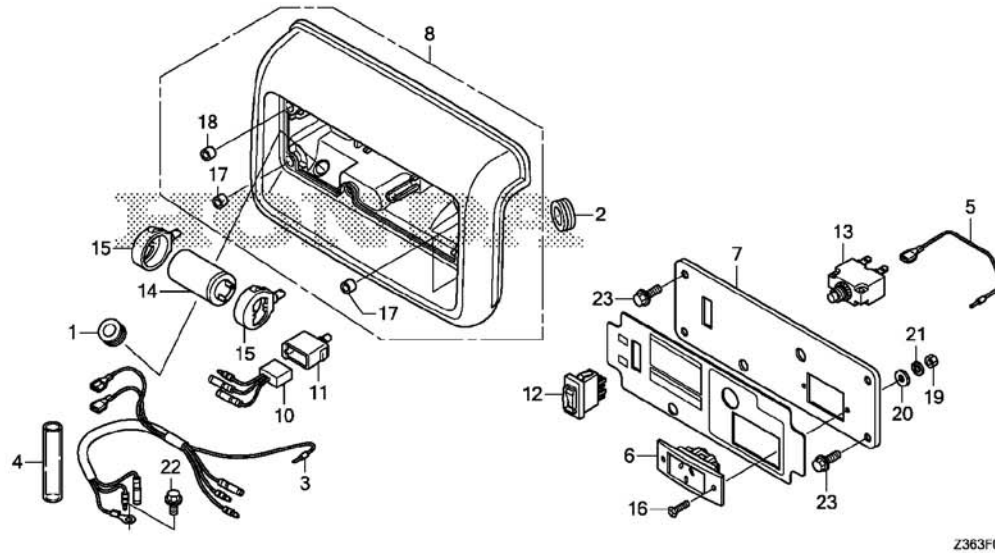

Z363F0201

Ref. No.	L.O.N.	(Relative ref. Number) Description	F.R.T.
3	6111B9	HARNES, CONTROL WIRE .....	0.3
5	6111F1	CORD, TERMINAL .....	0.2
6	6221D5	RECEPTACLE/CONSENT, CONTROL PANEL .....	0.2
7	6221N9	PANEL, GENERATOR CONTROL .....	0.3
8	4131M5	CASE, CONTROL .....	0.3
10	6151A0	ALERT UNIT, ENGINE OIL .....	0.3
12	6151D9	SWITCH, ENGINE STOP .....	0.2
13	6221D4	PROTECTOR, CIRCUIT .....	0.2
14	6221J9	CONDENSER, CONTROL BOX .....	0.3

Ref. No.	Part No.	Description	Reqd. QTY		Serial No.	Parts catalogue code
			EG 1000 N	EP 1000 N		
1	31472-Z36-D60	GROMMET, CONTROL HARNESS .....	1	-	-----	RA
2	31473-ZR3-S40	GROMMET, UNIT SWITCH .....	1	-	-----	RA
3	32150-Z36-R20	HARNES ASSY., CONTROL WIRE .....	1	-	-----	RA
4	32151-Z36-D60	TUBE, CONTROL HARNESS .....	1	-	-----	RA
5	32221-Z36-R20	CORD, TERMINAL .....	1	-	-----	RA
6	32330-Z36-R20	RECEPTACLE(10A/250V) .....	1	-	-----	RA
7	32345-Z36-R20	PANEL, CONTROL .....	1	-	-----	RA
8	32350-Z36-D60ZA	CASE COMP., CONTROL PANEL *R280*.....POWER RED	1	-	-----	RA
10	34150-Z36-D61	ALERT UNIT, OIL .....	1	-	-----	RA
11	34152-Z36-D60	CUSHION, OIL ALERT UNIT .....	1	-	-----	RA
12	35120-Z36-D61	SWITCH ASSY., ENGINE STOP(RED)	1	-	-----	RA
13	38240-Z36-D61	PROTECTOR, CIRCUIT(4.0A) .....	1	-	-----	RA
14	38386-ZR9-S50	CONDENSER .....	1	-	-----	RA
15	38387-Z36-D60	CUSHION, CAPACITOR .....	2	-	-----	RA
16	90101-Z36-R20	SCREW, FLAT, 3X12 .....	2	-	-----	RA
17	91551-Z15-000	COLLAR, CONTROL CASE .....	3	-	-----	RA
18	91555-Z36-D60	COLLAR, CONTROL CASE .....	1	-	-----	RA
19	94001-03080-0S	NUT, HEX., 3MM .....	2	-	-----	RA
20	94101-03800	WASHER, PLAIN, 3MM .....	2	-	-----	RA
21	94111-03800	WASHER, SPRING, 3MM .....	2	-	-----	RA
22	95701-06012-08	BOLT, FLANGE, 6X12 .....	1	-	-----	RA
23	95701-06018-07	BOLT, FLANGE, 6X18 .....	4	-	-----	RA

F-9

RECOIL STARTER

F 4

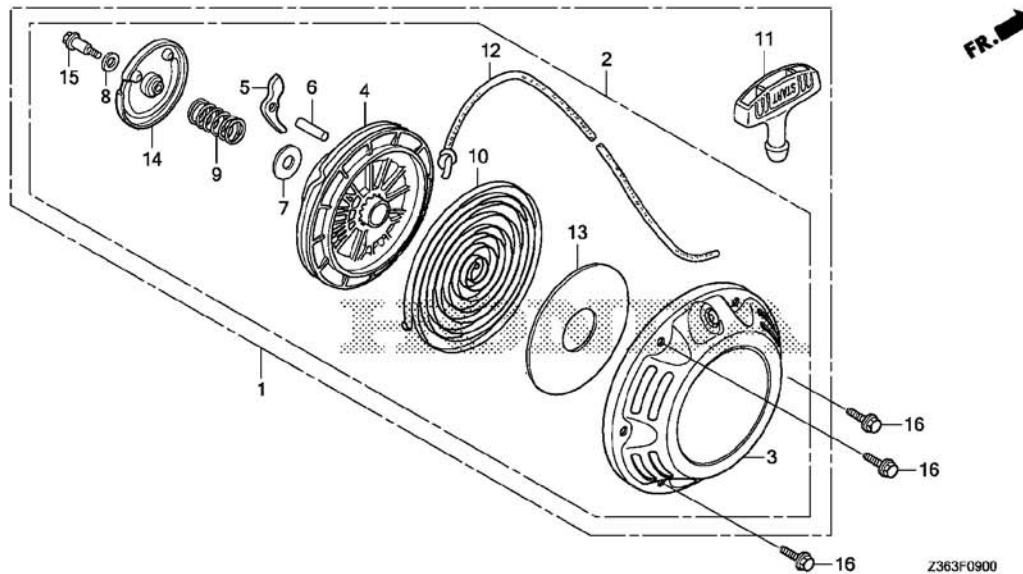

Z363F0900

Ref. No.	L.O.N.	(Relative ref. Number) Description	F.R.T.
1		(2)	
1	1121B9	STARTER, RECOIL .....	0.1
4	1121B1	REEL, RECOIL STARTER .....	0.3
5	1121B0	STARTER RATCHET AND/OR SPRING (14)	0.2
9	1121D6	SPRING, FRICTION .....	0.2
10	1121B7	SPRING, RECOIL STARTER RETURN	0.3
11	1121A3	GRIP, RECOIL STARTER .....	0.1
12	1121B3	ROPE, RECOIL STARTER .....	0.3

3

Ref. No.	Part No.	Description	Reqd. QTY		Serial No.	Parts catalogue code
			EG 1000 N	EP 1000 N		
1	28400-Z36-D60ZA	STARTER ASSY., RECOIL *NH105*...MAT BLACK (#15-#20)	1	-		
2	28400-Z36-R00ZA	STARTER ASSY., RECOIL *NH105*...MAT BLACK (#15-#20)	-	1		
3	28410-Z36-D60ZA	CASE COMP., RECOIL STARTER *NH105*...MAT BLACK (#15-#20)	1	1		
4	28421-Z1B-D10	REEL, STARTER .....	1	1		
5	28422-Z1B-D10	RATCHET, STARTER .....	1	1		
6	28423-Z1B-D10	SHAFT, RATCHET .....	1	1		
7	28431-Z1B-D10	PLATE A, FRICTION .....	1	1		
8	28432-883-T20	PLATE B, FRICTION .....	1	1		
9	28441-883-T20	SPRING, FRICTION .....	1	1		
10	28443-Z1B-D10	SPRING, RETURN .....	1	1		
11	28461-Z1B-D10	GRIP, STARTER .....	1	1		
12	28462-Z36-D60	ROPE, RECOIL STARTER .....	1	-		
	28462-Z1B-D10	.....	-	1		
13	28467-Z1B-D10	PLATE, SIDE .....	1	1		
14	28474-Z1B-D10	COVER, REEL STARTER .....	1	1		
15	90003-883-T20	BOLT, REEL COVER .....	1	1		
16	90013-883-000	BOLT, FLANGE, 6X12(CT200) ...	3	3		

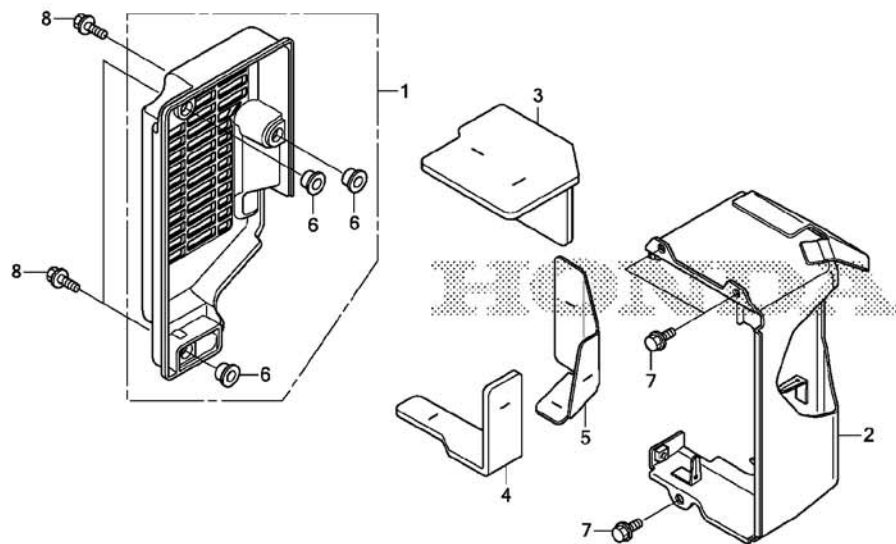

Ref. No.	L.O.N.	(Relative ref. Number) Description	F.R.T.
1	3131D9	PROTECTOR, EXHAUST MUFFLER : OUTER .....	0.1
	3131G9	PROTECTOR, EXHAUST MUFFLER : BOTH .....	0.3
2	3131D8	PROTECTOR, EXHAUST MUFFLER : INNER .....	0.3
	3131G9	PROTECTOR, EXHAUST MUFFLER : BOTH .....	0.3
3	(4,5)		
	3131B9	INSULATOR, MUFFLER PROTECTOR	0.2

Ref. No.	Part No.	Description	Reqd. QTY		Serial No.	Parts catalogue code
			EG 1000 N	EP 1000 N		
1	18320-Z36-R00ZA	PROTECTOR COMP., OUTER MUFFLER *NH105*...MAT BLACK (#15-#20)	-	1		
2	18325-Z36-R00	PROTECTOR COMP., INNER MUFFLER	-	1		
3	18376-Z36-R00	INSULATOR, UPPER MUFFLER	-	1		
4	18377-Z36-R00	INSULATOR, LOWER MUFFLER	-	1		
5	18378-Z36-R00	INSULATOR, SIDE MUFFLER	-	1		
6	91552-Z36-D60	COLLAR, SHROUD .....	-	3		
7	95701-06010-08	BOLT, FLANGE, 6X10 .....	-	3		
8	95701-06016-07	BOLT, FLANGE, 6X16 .....	-	3		

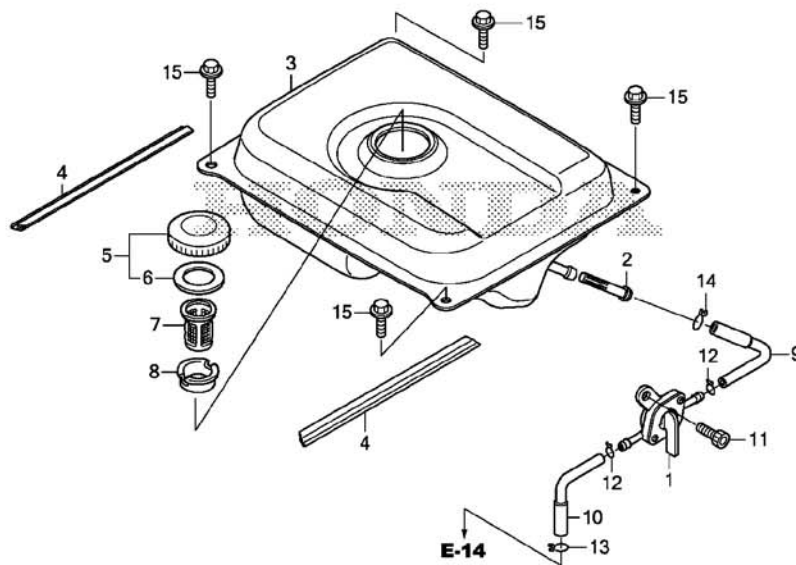

Ref. No.	L.O.N.	(Relative ref. Number) Description	F.R.T.
1	3101A3	COCK, FUEL .....	0.2
2	3101H8	STRAINER, FUEL .....	0.5
3	3101H7	TANK, FUEL .....	0.5
5		(6)	
	3101M7	CAP, FUEL FILLER .....	0.1
7	3101A6	FILTER, FUEL .....	0.1
9	3101F1	TUBE, FUEL TANK .....	0.5
10	3101F6	TUBE, FUEL .....	0.2

3

Ref. No.	Part No.	Description	Reqd. QTY		Serial No.	Parts catalogue code
			EG 1000 N	EP 1000 N		
1	16950-Z36-003	COCK ASSY., FUEL .....	1	1		
2	16952-Z36-000	STRAINER, FUEL .....	1	1		
3	17510-Z36-D60ZA	TANK COMP., FUEL *R280*.....POWER RED	1	1		
4	17537-Z36-R00	RUBBER, FUEL TANK .....	-	2		
5	17620-ZC5-N40	CAP COMP., FUEL FILLER .....	1	1		
6	17631-ZC5-N41	PACKING, FUEL FILLER CAP (39X58X3)	1	1		
7	17670-Z36-D60	FILTER COMP., FUEL .....	1	1		
8	17673-ZC5-K40	HOLDER, FUEL FILTER .....	1	1		
9	17701-Z36-000	TUBE, FUEL TANK .....	1	1		
10	17702-Z36-000	TUBE, FUEL COCK .....	1	-		
	17702-Z36-R00	.....	-	1		
11	90049-KBH-000	BOLT, SOCKET, 5X14 .....	1	1		
12	95002-02080	CLIP, TUBE(B8) .....	2	2		
13	95002-50000	CLIP, TUBE(C9) .....	1	1		
14	95002-70000	CLIP, TUBE(C11) .....	1	1		
15	95701-06012-07	BOLT, FLANGE, 6X12 .....	4	4		

F-21

FAN COVER/SHROUD

F 7

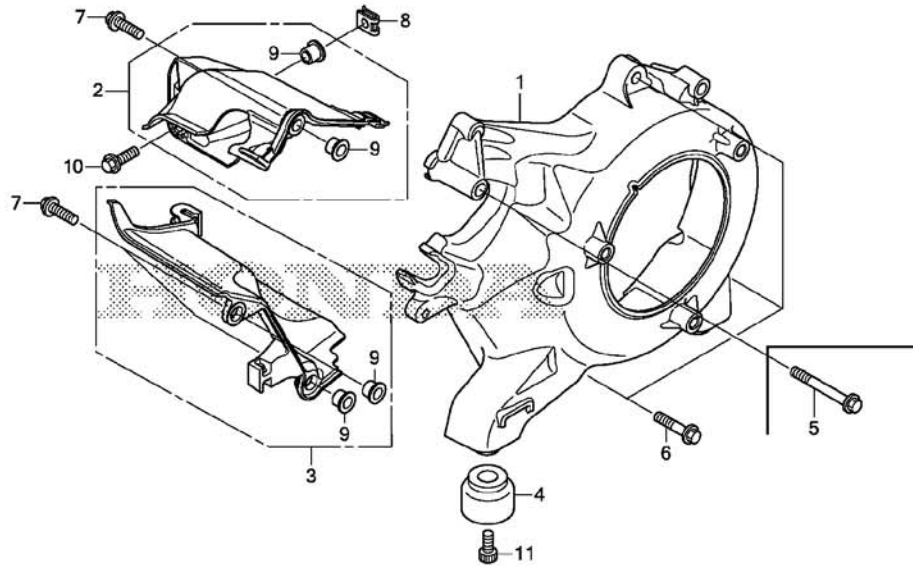

Z363F2100

Ref. No.	L.O.N.	(Relative ref. Number) Description	F.R.T.
1	1141G8	COVER, ENGINE COOLING FAN .... .INCLUDES: Engine removal and installation	1.2
	1141G9	COVER, ENGINE COOLING FAN(A) . .NOTE: EG model	0.8
2	4141E2	SHROUD, ENGINE :UPPER .....	0.2
3	4141E0	SHROUD, ENGINE :LOWER .....	0.2
	4141AP	SHROUD, ENGINE(A) :LOWER .....	0.1
		.NOTE: EG model	
4	4101Q6	RUBBER, BOTTOM .....	0.1
		.NOTE: Same time for two units	
	4101EE	RUBBER, BOTTOM :FOR 1 PRODUCT	0.2

Ref. No.	Part No.	Description	Reqd. QTY		Serial No.	Parts catalogue code
			EG 1000 N	EP 1000 N		
1	19611-Z36-405	COVER, FAN .....	1	1		
2	19630-Z36-D60	SHROUD COMP., UPPER .....	1	1		
3	19640-Z36-D60	SHROUD COMP., LOWER .....	1	1		
4	68325-Z36-D60	RUBBER, BOTTOM .....	2	-		
5	90014-888-000	BOLT, FLANGE, 6X50 .....	-	1		
6	90015-883-000	BOLT, FLANGE, 6X28(CT200) ...	3	3		
7	90022-888-010	BOLT, FLANGE, 6X20(CT200) ...	3	3		
8	90320-747-000	NUT, SPRING, 6MM .....	1	1		
9	91552-Z36-D60	COLLAR, SHROUD .....	4	4		
10	95701-06018-07	BOLT, FLANGE, 6X18 .....	1	1		
11	96700-06014-08	BOLT, SOCKET, 6X14 .....	2	-		

3

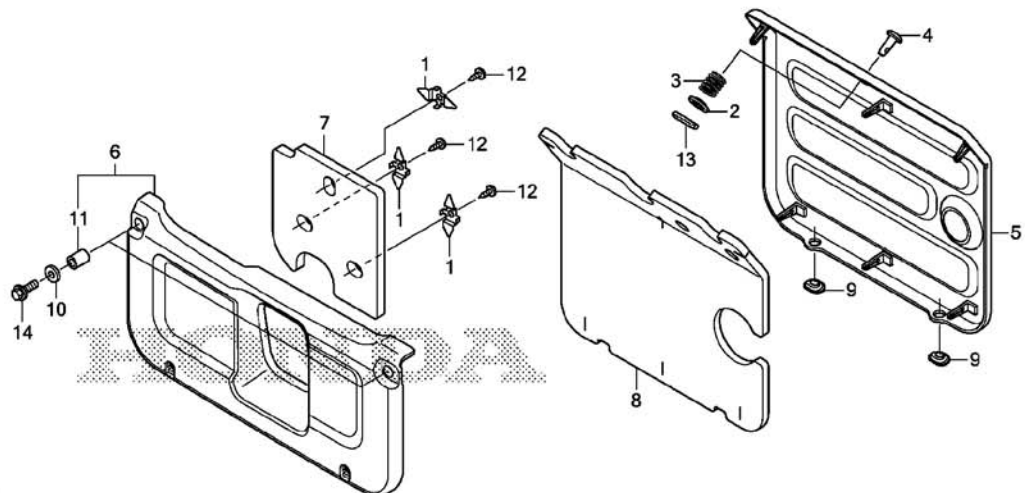

Z363F2200

Ref. No.	L.O.N.	(Relative ref. Number) Description	F.R.T.
5	4101E0	COVER, GENERATOR :REAR .....	0.2
6	410107	COVER, GENERATOR :FRONT .....	0.1
7	4141Q3	INSULATOR, PANEL :FRONT .....	0.1
8	4141Q5	INSULATOR, PANEL :REAR .....	0.1

3

Ref. No.	Part No.	Description	Reqd. QTY		Serial No.	Parts catalogue code
			EG 1000 N	EP 1000 N		
1	19656-Z25-R50	CLIP, INSULATOR .....	-	3		
2	50129-862-000	RETAINER, LOCK SPRING .....	-	1		
3	63173-Z25-000	SPRING, COVER LOCK .....	-	1		
4	63175-Z36-R00	PIN, COVER LOCK .....	-	1		
5	63310-Z36-R00ZA	COVER COMP., RR. *NH105*...MAT BLACK (#15-#20)	-	1		
6	63510-Z36-R00ZA	COVER COMP., FR. *NH105*...MAT BLACK (#15-#20)	-	1		
7	64311-Z36-R00	INSULATOR, FR. COVER .....	-	1		
8	64411-Z36-R00	INSULATOR, RR. COVER .....	-	1		
9	83551-Z36-R00	GROMMET, RR. COVER .....	-	2		
10	90439-MB0-000	WASHER, RR. COVER GROMMET ...	-	2		
11	91555-Z36-D60	COLLAR, CONTROL CASE .....	-	2		
12	93913-25210	SCREW, TAPPING, 5X12 .....	-	3		
13	94305-40203	PIN, SPRING, 4X20 .....	-	1		
14	95701-06018-07	BOLT, FLANGE, 6X18 .....	-	2		

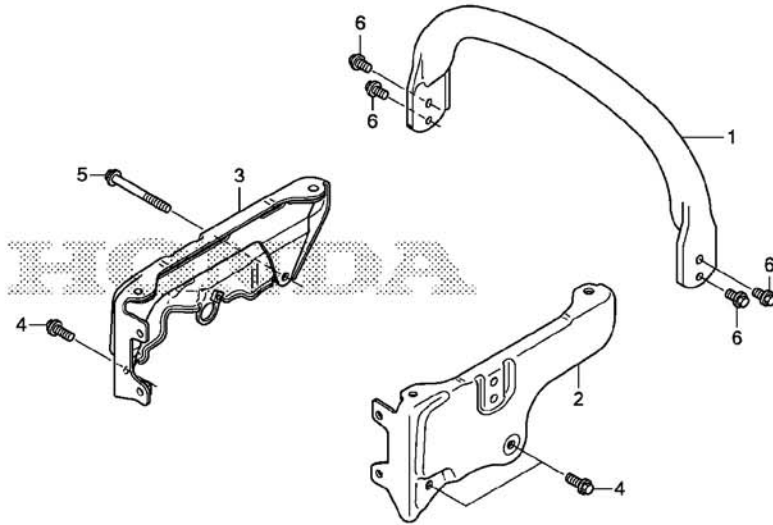

Z363F2500

Ref. No.	L.O.N.	(Relative ref. Number) Description	F.R.T.
1	5101R1	HANDLE, GENERATOR CARRYING ...	0.1
2	4101J5	FRAME, SIDE :LEFT .....	0.4
.NOTE: Same time for two units			
3	4101J6	FRAME, SIDE :RIGHT .....	0.4
.NOTE: Same time for two units			

Ref. No.	Part No.	Description	Reqd. QTY		Serial No.	Parts catalogue code
			EG 1000 N	EP 1000 N		
1	53101-Z36-D60ZA	HANDLE, CARRY *NH105*...MAT BLACK (#15-#20)	1	-		
2	63640-Z36-D60ZA	FRAME COMP., R. SIDE *NH105*...MAT BLACK (#15-#20)	1	-		
3	63650-Z36-D60ZA	FRAME COMP., L. SIDE *NH105*...MAT BLACK (#15-#20)	1	-		
4	90029-888-000	BOLT, FLANGE, 6X16(CT200) ...	3	-		
5	90101-Z36-D60	BOLT, FLANGE, 6X55(CT200) ...	1	-		
6	95701-06010-07	BOLT, FLANGE, 6X10 .....	4	-		

F-25-1

FRAME(EP1000N)

F10

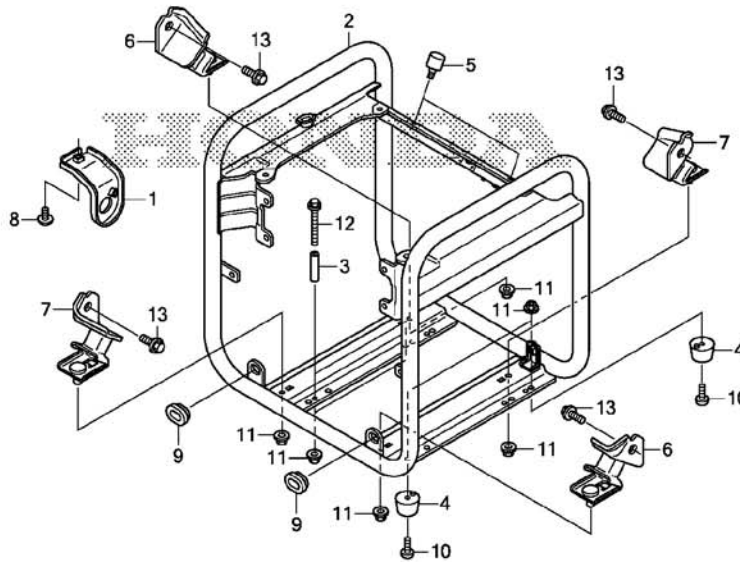

Ref. No.	L.O.N.	(Relative ref. Number) Description	F.R.T.
2	4101H6	FRAME, MAIN ..... .INCLUDES: Engine removal and installation	1.1
4	4101Z5	RUBBER, FRAME BOTTOM .....	0.1
	4101Z6	RUBBER, FRAME BOTTOM :ALL .... (?)	0.2
6	4101Q9	RUBBER, ENGINE MOUNTING ..... .INCLUDES: Engine removal and installation	0.8
	4101T3	RUBBER, ENGINE MOUNTING :ALL . .INCLUDES: Engine removal and installation	0.9

3

Ref. No.	Part No.	Description	Reqd. QTY		Serial No.	Parts catalogue code
			EG 1000 N	EP 1000 N		
1	16956-Z36-R00	BRACKET, FUEL COCK .....	-	1		
2	50310-Z36-R00ZA	FRAME COMP. *NH105*...MAT BLACK (#15-#20)	-	1		
3	53364-Z36-R00	COLLAR, STOPPER .....	-	2		
4	60407-812-000	RUBBER, BOTTOM .....	-	4		
5	61313-Z36-R00	RUBBER, RR. COVER UPPER .....	-	2		
6	68324-Z36-R00	RUBBER, FR. MOUNTING .....	-	2		
7	68328-Z36-R00	RUBBER, RR. MOUNTING .....	-	2		
8	90106-MAV-000	SCREW, PAN, 6X12 .....	-	1		
9	91651-Z36-R00	GROMMET, FR. COVER .....	-	2		
10	93500-06014-0H	SCREW, PAN, 6X14 .....	-	4		
11	94050-06080	NUT, FLANGE, 6MM .....	-	10		
12	95701-06055-08	BOLT, FLANGE, 6X55 .....	-	2		
13	95701-08018-08	BOLT, FLANGE, 8X18 .....	-	4		

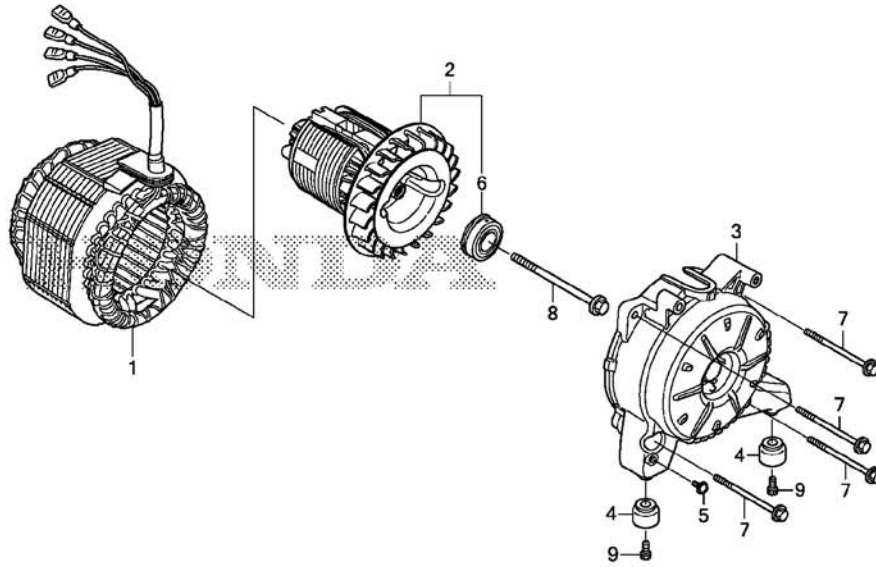

Ref. No.	L.O.N.	(Relative ref. Number) Description	F.R.T.
1	6201B9	STATOR, GENERATOR ..... .INCLUDES: Engine removal and installation	1.3
	6201G4	STATOR, GENERATOR(A) ..... .NOTE: EG model	0.8
2	6201A9	ROTOR, GENERATOR ..... .INCLUDES: Engine removal and installation	1.3
	6201G2	ROTOR, GENERATOR(A) ..... .NOTE: EG model	0.8
3	6201B6	HOUSING, GENERATOR :REAR ..... .INCLUDES: Engine removal and installation	1.0
	6201G1	HOUSING, GENERATOR(A) :REAR .. .NOTE: EG model	0.5
4	4101Q6	RUBBER, BOTTOM ..... .NOTE: Same time for two units	0.1
	4101EE	RUBBER, BOTTOM :FOR 1 PRODUCT	0.2
6	6201A7	BEARING, GENERATOR ROTOR ..... .INCLUDES: Engine removal and installation	1.3
	6201G3	BEARING, GENERATOR ROTOR(A) .. .NOTE: EG model	0.8

Ref. No.	Part No.	Description	Reqd. QTY		Serial No.	Parts catalogue code
			EG 1000 N	EP 1000 N		
1	31120-Z36-D80	STATOR ASSY. ....	1	-	----- K	
	31120-Z36-D30	.....	1	-	----- L	
	31120-Z36-R70	.....	1	-	----- LS	
	31120-Z36-D60	.....	1	-	----- M,R	
	31120-Z36-R20	.....	1	-	----- RA	
	31120-Z36-C70	.....	1	-	----- S	
	31120-Z36-R60	.....	-	1	----- R	
	31120-Z36-R00	.....	-	1	----- RDN	
2	31130-Z36-D60	ROTOR COMP. ....	1	1		
3	31171-Z36-405	HOUSING, RR. ....	1	1		
4	68325-Z36-D60	RUBBER, BOTTOM .....	2	-		
5	90102-899-003	SCREW, PAN, 5X12 .....	1	1		
6	91051-Z36-D61	BEARING ASSY., 6002 .....	1	1		
7	95701-06090-08	BOLT, FLANGE, 6X90 .....	4	4		
8	95801-08130-08	BOLT, FLANGE, 8X130 .....	1	1		
9	96700-06014-08	BOLT, SOCKET, 6X14 .....	2	-		



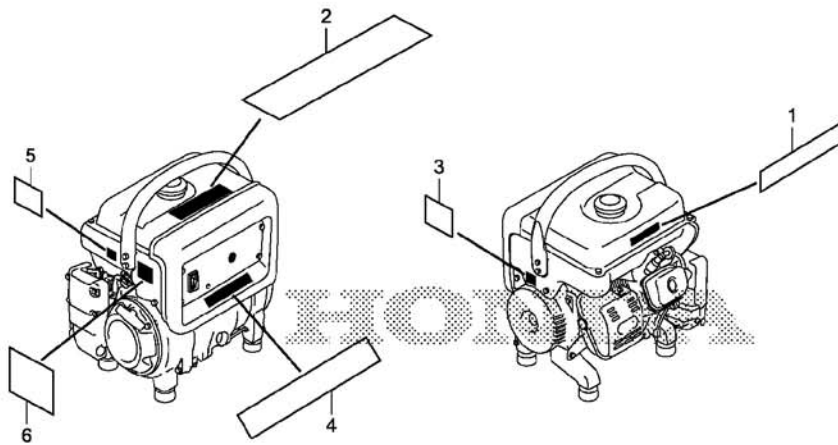

Z363F3100

Ref. No.	L.O.N.	(Relative ref. Number) Description	F.R.T.
----------	--------	---------------------------------------	--------

NO INFORMATION .....

3

Ref. No.	Part No.	Description	Reqd. QTY		Serial No.	Parts catalogue code
			EG 1000 N	EP 1000 N		
1	87125-Z36-D60	MARK, HONDA .....	1	-		
2	87150-Z36-D60	MARK A, CAUTION .....	1	-		
3	87178-Z36-D80	MARK, DIRECTION .....	1	-	----- K,LS,RA	
4	87531-Z36-D60	MARK, HONDA .....	1	-		
5	87565-Z36-D60	MARK, FUEL .....	1	-		
6	87594-Z36-D60	MARK, OIL CAUTION .....	1	-		

F-31-1

LABEL(EP1000N)

F13

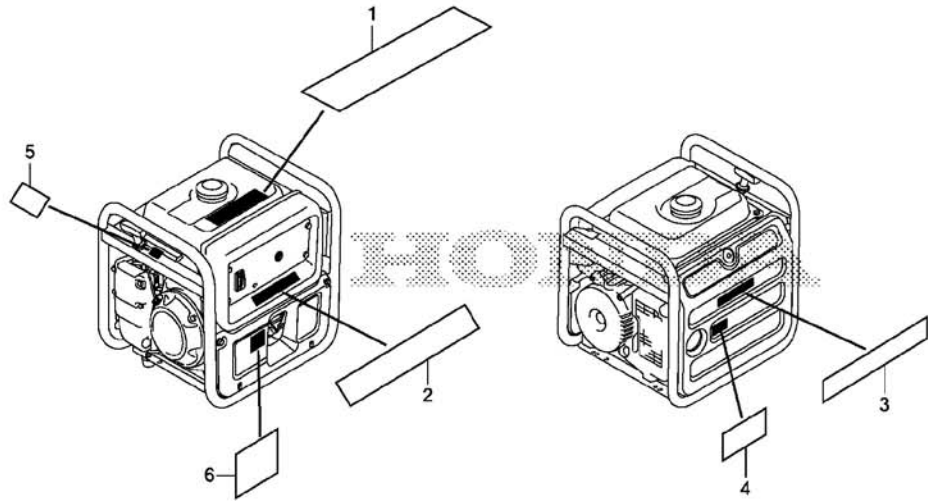

Z363F3101

Ref. No.	L.O.N.	(Relative ref. Number) Description	F.R.T.
----------	--------	---------------------------------------	--------

NO INFORMATION .....

Ref. No.	Part No.	Description	Reqd. QTY		Serial No.	Parts catalogue code
			EG 1000 N	EP 1000 N		
1	87150-Z36-D60	MARK A, CAUTION .....	-	1		
2	87531-Z36-D60	MARK, HONDA .....	-	1		
3	87531-Z36-R00	MARK, HONDA .....	-	1		
4	87539-Z36-R00	MARK, EX. CAUTION .....	-	1		
5	87565-Z36-D60	MARK, FUEL .....	-	1		
6	87594-Z36-D60	MARK, OIL CAUTION .....	-	1		

3

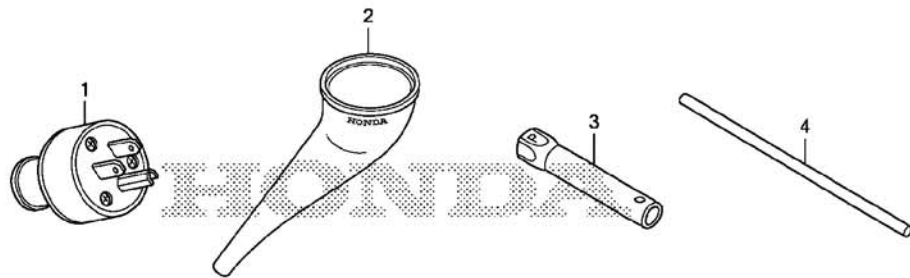

Z363F3200

Ref. L.O.N. (Relative ref. Number) F.R.T.  
No. Description

NO INFORMATION .....

3

Ref. No.	Part No.	Description	Reqd. QTY		Serial No.	Parts catalogue code
			EG 1000 N	EP 1000 N		
1	32310-Z36-D61	PLUG ASSY.(15A/250V) .....	1	-	----- K,L,LS,M,R,S	
2	89115-Z09-S40	FUNNEL, OIL .....	-	1		
3	89216-Z36-D60	WRENCH, PLUG(P16) .....	1	1		
4	89219-805-000	HANDLE, BOX WRENCH .....	1	1		

# PART NO. INDEX

G 1

Part Number	Address	Page	Ref.	Part Number	Address	Page	Ref.	Part Number	Address	Page	Ref.	Part Number	Address	Page	Ref.	Part Number	Address	Page	Ref.
11000				16101-ZCJ-003	D13	30	2	17701-236-000	F6	42	9	31120-236-R60	F11	47	1		F3	39	15
11310-ZCJ-000	D4	21	1	16102-ZCJ-003	D13	30	3	17702-236-000	F6	42	10	31120-236-R70	F11	47	1				
11381-ZCJ-000	D4	21	2	16103-ZCJ-003	D13	30	4	17702-236-R00	F6	42	10	31130-236-D60	F11	47	2	50000			
				16104-ZCJ-003	D13	30	5					31171-236-405	F11	47	3				
				16105-ZCJ-003	D13	30	6	18000				31472-236-D60	F1	37	1	50129-862-000	F8	44	2
12000				16106-ZCJ-003	D13	30	7					F3	39	1	50310-236-R00ZA	F10	46	2	
12000-ZCJ-405	D3	20	1	16107-ZCJ-003	D13	30	8	18310-ZCJ-000	D16	33	1	31473-ZR3-S40	F1	37	2				
12204-ZCJ-305	D1	18	1	16108-ZCJ-003	D13	30	9	18310-ZCJ-900	D16	33	2	F3	39	2	53000				
12205-ZCJ-305	D1	18	2	16109-ZCJ-003	D13	30	10	18320-236-R00ZA	F5	41	1	31914-Z8Y-003	D1	18	8				
12209-GB4-682	D8	25	1	16110-ZCJ-003	D13	30	11	18325-236-R00	F5	41	2				53101-236-D60ZA	F9	45	1	
12210-ZCJ-405	D1	18	3	16111-ZCJ-003	D13	30	12	18376-236-R00	F5	41	3	32000			53364-236-R00	F10	46	3	
12251-ZCJ-003	D1	18	4	16112-ZCJ-003	D13	30	13	18377-236-R00	F5	41	4								
12310-ZCJ-000	D1	18	5	16113-ZCJ-003	D13	30	14	18378-236-R00	F5	41	5	32150-236-D30	F1	37	3	60000			
12312-ZCJ-000	D1	18	6	16114-ZCJ-003	D13	30	15	18381-ZCJ-000	D16	33	3	32150-236-D60	F1	37	3				
				16115-ZCJ-003	D13	30	16					32150-236-R00	F1	37	3	60407-812-000	F10	46	4
				16116-ZCJ-003	D13	30	17	19000				32150-236-R20	F3	39	3				
				16117-ZCJ-003	D13	30	18					32151-236-D60	F1	37	4	61000			
				16118-ZCJ-003	D13	30	19	19511-ZCJ-000	E1	34	1	F3	39	4					
13010-ZCJ-004	D7	24	1	16119-ZCJ-003	D13	30	20	19611-236-405	F7	43	1	32221-236-D30	F1	37	5	61313-236-R00	F10	46	5
13010-ZCJ-005	D7	24	1	16211-ZCJ-000	D13	30	21	19630-236-D60	F7	43	2	32221-236-D60	F1	37	5				
13011-ZCJ-004	D7	24	1	16212-ZCJ-000	D13	30	22	19640-236-D60	F7	43	3	32221-236-R20	F3	39	5	63000			
13011-ZCJ-005	D7	24	1	16269-ZA8-010	D13	30	23	19656-Z25-R50	F8	44	1	32310-236-D61	F14	50	1				
13012-ZCJ-004	D7	24	1	16510-ZCJ-000	D4	21	5					32330-236-D61	F1	37	7	63173-Z25-000	F8	44	3
13012-ZCJ-005	D7	24	1	16511-ZCJ-000	D4	21	6	28000				32330-236-R01	F1	37	8	63175-236-R00	F8	44	4
13101-ZCJ-000	D7	24	2	16512-ZDA-000	D4	21	7					32330-236-R20	F3	39	6	63310-236-R00ZA	F8	44	5
13102-ZCJ-000	D7	24	2	16513-ZDA-000	D4	21	8	28400-236-D60ZA	F4	40	1	32345-236-D60	F1	37	10	63510-236-R00ZA	F8	44	6
13103-ZCJ-000	D7	24	2	16531-ZDB-000	D4	21	9	28400-236-R00ZA	F4	40	2	32345-236-R20	F3	39	7	63640-236-D60ZA	F9	45	2
13111-ZCJ-000	D7	24	3	16541-ZDB-000	D3	20	2	28410-236-D60ZA	F4	40	3	32350-236-D60ZA	F1	37	11	63650-236-D60ZA	F9	45	3
13115-ZCJ-000	D7	24	4	16551-ZCJ-000	E3	36	1	28421-21B-D10	F4	40	4	F3	39	8					
13200-ZCJ-000	D7	24	5	16555-ZCJ-000	E3	36	2	28422-21B-D10	F4	40	5	32366-236-C70	F1	37	12	64000			
13200-ZCJ-305	D7	24	5	16561-ZCJ-000	E3	36	3	28423-21B-D10	F4	40	6	32366-236-D30	F1	37	12				
13310-ZCJ-000	D6	23	1	16561-ZCJ-820	E3	36	3	28431-21B-D10	F4	40	7	32366-236-D60	F1	37	12	64311-236-R00	F8	44	7
13310-ZCJ-800	D6	23	1	16562-ZCJ-000	E3	36	4	28432-883-T20	F4	40	8	32366-236-R00	F1	37	12	64411-236-R00	F8	44	8
				16571-836-000	E3	36	5	28441-883-T20	F4	40	9	32366-236-R60	F1	37	12				
				16571-ZCJ-000	E3	36	6	28443-21B-D10	F4	40	10	32366-236-R70	F1	37	12	68000			
				16571-ZCJ-800	E3	36	6	28451-ZCJ-000	E1	34	2								
14000				16581-ZCJ-000	E3	36	7	28461-21B-D10	F4	40	11	34000			68324-236-R00	F10	46	6	
14100-ZCJ-000	D8	25	2	16581-ZCJ-800	E3	36	7	28462-21B-D10	F4	40	12				68325-236-D60	F7	43	4	
14100-ZCJ-800	D8	25	2	16950-236-003	F6	42	1	28462-236-D60	F4	40	12	34150-236-D61	F1	37	13				
14410-ZCJ-000	D8	25	3	16952-236-000	F6	42	2	28467-21B-D10	F4	40	13	F3	39	10	68328-236-R00	F10	46	7	
14410-ZCJ-800	D8	25	3	16956-236-R00	F10	46	1	28474-21B-D10	F4	40	14	F3	39	11					
14431-ZCJ-000	D8	25	4									34152-236-D60	F1	37	14	83000			
14441-ZCJ-000	D8	25	5	17000				30000				F3	39	11					
14460-ZCJ-000	D8	25	6												83551-236-R00	F8	44	9	
14711-ZCJ-000	D8	25	7	17211-ZCJ-000	D15	32	1	30500-ZCJ-003	E2	35	1	35000							
14721-ZCJ-000	D8	25	8	17220-ZCJ-000	D15	32	2	30500-ZCJ-831	E2	35	2	35120-236-D61	F1	37	15	87000			
14731-ZCJ-000	D8	25	9	17222-ZCJ-000	D13	30	24	30700-ZCJ-003	E2	35	3	F3	39	12					
14751-ZCJ-000	D8	25	10	17223-ZCJ-000	D15	32	3	30700-ZCJ-831	E2	35	3	35480-ZCJ-003	D3	20	4	87125-236-D60	F12	48	1
14771-ZCJ-000	D8	25	11	17226-ZC0-000	D15	32	4	30701-883-000	D3	20	3	35481-ZCJ-000	D3	20	5	87150-236-D60	F12	48	2
14781-MA6-000	D8	25	12	17227-ZC0-000	D15	32	5									F13	49	1	
				17227-ZCJ-000	D15	32	6	31000									F12	48	3
				17229-ZCJ-000	D15	32	7					38000					F12	48	4
15000				17247-ZCJ-000	D15	32	5	31110-ZCJ-000	E1	34	3	38240-236-C71	F1	37	16	87531-236-D60	F12	48	4
15600-ZCJ-010	D4	21	3	17510-236-D60ZA	F6	42	3	31120-236-C70	F11	47	1	38240-236-D31	F1	37	16				
15625-Z0T-800	D4	21	4	17537-236-R00	F6	42	4	31120-236-D30	F11	47	1	38240-236-D61	F1	37	16	87531-236-R00	F13	49	3
15721-ZCJ-000	D1	18	7	17620-ZC5-N40	F6	42	5	31120-236-D60	F11	47	1	F3	39	13	87539-236-R00	F13	49	4	
				17631-ZC5-N41	F6	42	6	31120-236-D80	F11	47	1	38386-ZR9-S50	F1	37	17	87565-236-D60	F12	48	5
				17670-236-D60	F6	42	7	31120-236-R00	F11	47	1	F3	39	14					
				17673-ZC5-K40	F6	42	8	31120-236-R20	F11	47	1	F2	38	18	87594-236-D60	F12	48	6	
16100-ZCJ-003	D13	30	1													F13	49	6	

4

# PART NO. INDEX

**G 2**

Part Number	Address	Page	Ref.	Part Number	Address	Page	Ref.	Part Number	Address	Page	Ref.	Part Number	Address	Page	Ref.
89000				93500-04016-OH	E3	36	10								
				93500-06014-OH	F10	46	10								
89115-209-S40	F14	50	2	93913-25210	F8	44	12								
89216-236-D60	F14	50	3												
89219-805-000	F14	50	4	94000											
90000				94001-03080-OS	F3	39	19								
				94001-04080-OS	F2	38	24								
90001-ZCJ-000	D7	24	6	94050-06080	D13	30	25								
90001-ZDA-000	D3	20	6		D16	33	4								
90003-883-T20	F4	40	15		E3	36	11								
90003-KFG-000	D1	18	9		F10	46	11								
90012-896-750	D3	20	7	94050-12080	E1	34	4								
90012-ZCJ-000	D8	25	13	94101-03800	F3	39	20								
90013-883-000	E3	36	8	94101-04800	F2	38	26								
	F4	40	16	94101-06800	D3	20	11								
90014-888-000	F7	43	5		D4	21	14								
90015-883-000	D4	21	10	94111-03800	F3	39	21								
	F7	43	6	94251-08000	D3	20	12								
90015-ZE5-010	E3	36	9	94301-08140	D1	18	13								
90022-888-010	F7	43	7		D4	21	15								
90029-888-000	F9	45	4	94305-40203	F8	44	13								
90043-ZCJ-000	D1	18	10												
90045-892-000	D1	18	11	95000											
90049-KBH-000	F6	42	11												
90101-236-D60	F9	45	5	95002-02080	F6	42	12								
90101-236-R20	F3	39	16	95002-50000	F6	42	13								
90102-899-003	F11	47	5	95002-70000	F6	42	14								
90106-MAV-000	F10	46	8	95701-06010-07	F9	45	6								
90121-952-000	E2	35	4	95701-06010-08	F5	41	7								
90206-ZCJ-000	D8	25	14	95701-06012-07	F6	42	15								
90320-747-000	F7	43	8	95701-06012-08	D16	33	5								
90401-ZCJ-800	D8	25	15		F2	38	28								
90439-MB0-000	F8	44	10		F3	39	22								
90451-ZDA-000	D4	21	11	95701-06016-07	F5	41	8								
90543-MV9-670	D1	18	12	95701-06018-07	F2	38	29								
90601-ZE1-000	D3	20	8		F3	39	23								
90602-ZE1-000	D4	21	12		F7	43	10								
	D8	25	16		F8	44	14								
90741-147-000	D6	23	2	95701-06028-07	D15	32	8								
91000				95701-06050-08	D1	18	14								
				95701-06055-08	F10	46	12								
91051-236-D61	F11	47	6	95701-06090-08	F11	47	7								
91202-892-003	D3	20	9	95701-08018-08	F10	46	13								
	D4	21	13	95801-08130-08	F11	47	8								
91301-ZA8-004	D3	20	10	96000											
91551-Z15-000	F2	38	20												
	F3	39	17	96100-62030-00	D3	20	13								
91552-236-D60	F5	41	6		D4	21	16								
	F7	43	9	96700-06014-08	F7	43	11								
91555-236-D60	F2	38	21		F11	47	9								
	F3	39	18												
	F8	44	11	99000											
91651-236-R00	F10	46	9												
93000				99131-ZCJ-0500	D14	31	26								
				99131-ZCJ-0520	D14	31	26								
				99131-ZCJ-0550	D14	31	26								
93500-04012-1G	F2	38	22	99133-ZCJ-0320	D14	31	27								

4

# PART NAME INDEX

Part name	Address	Page	Ref.	Part name	Address	Page	Ref.	Part name	Address	Page	Ref.
[ A ]				[ C ]				[ F ]			
ALERT UNIT, OIL .....	F1	37	13	CAMSHAFT ASSY. ....	D8	25	2	FAN, COOLING .....	E1	34	1
	F3	39	10	CAP ASSY., NOISE SUPPRESSOR ...	E2	35	3	FILTER .....	D13	30	9
ARM, EX. VALVE ROCKER .....	D8	25	5	CAP ASSY., OIL FILLER .....	D4	21	3	FILTER COMP., FUEL .....	F6	42	7
ARM, GOVERNOR .....	E3	36	1	CAP COMP., FUEL FILLER .....	F6	42	5	FLOAT SET .....	D13	30	17
ARM, IN. VALVE ROCKER .....	D8	25	4	CARBURETOR ASSY. ....	D13	30	1	FLYWHEEL COMP. ....	E1	34	3
[ B ]				CASE COMP., AIR CLEANER .....	D15	32	2	FRAME COMP. ....	F10	46	2
BARREL ASSY., CYLINDER .....	D3	20	1	CASE COMP., AIR CLEANER				FRAME COMP., L. SIDE .....	F9	45	3
BASE, AIR CLEANER .....	D13	30	24	CASE COMP., CONTROL PANEL .....	F1	37	11	FRAME COMP., R. SIDE .....	F9	45	2
BASE, CONTROL .....	E3	36	7	ELEMENT D15		32	3	FUNNEL, OIL .....	F14	50	2
BEARING ASSY., 6002 .....	F11	47	6	CASE COMP., RECOIL STARTER ....	F3	39	8	[ G ]			
BEARING, RADIAL BALL, 6203 ...	D3	20	13	CLIP .....	F4	40	3	GASKET, AIR CLEANER .....	D13	30	23
	D4	21	16	CLIP, GOVERNOR HOLDER .....	D13	30	11	GASKET, CYLINDER HEAD .....	D1	18	4
BODY, FLOAT CHAMBER .....	D13	30	16	CLIP, HIGH TENSION CORD .....	D4	21	12	GASKET, MUFFLER .....	D16	33	3
BOLT, CONNECTING ROD .....	D7	24	6	CLIP, INSULATOR .....	D8	25	16	GOVERNOR ASSY. ....	D4	21	5
BOLT, DRAIN PLUG, 10MM .....	D3	20	6	CLIP, PISTON PIN, 12MM .....	D3	20	3	GRIP, STARTER .....	F4	40	11
BOLT, FLANGE, 5X14 .....	D3	20	7	CLIP, TUBE .....	D7	24	4	GROMMET, CONTROL HARNESS .....	F1	37	1
BOLT, FLANGE, 6X10 .....	F5	41	7		D13	30	7		F3	39	1
	F9	45	6		F6	42	12	GROMMET, FR. COVER .....	F10	46	9
BOLT, FLANGE, 6X12 .....	D16	33	5				13	GROMMET, RR. COVER .....	F8	44	9
	E3	36	8	COCK ASSY., FUEL .....	F6	42	1	GROMMET, UNIT SWITCH .....	F1	37	2
	F2	38	28	COIL ASSY., IGNITION .....	E2	35	1	GUIDE, EX. VALVE .....	F3	39	2
	F3	39	22				2	GUIDE, IN. VALVE .....	D1	18	2
	F4	40	16	COLLAR, CONTROL CASE .....	F2	38	20		D1	18	1
	F6	42	15				21	[ H ]			
BOLT, FLANGE, 6X16 .....	F5	41	8		F3	39	17	HANDLE, BOX WRENCH .....	F14	50	4
	F9	45	4		F8	44	11	HANDLE, CARRY .....	F9	45	1
BOLT, FLANGE, 6X18 .....	F2	38	29	COLLAR, SHROUD .....	F5	41	6	HARNES ASSY., CONTROL WIRE ...	F1	37	3
	F3	39	23		F7	43	9		F3	39	3
	F7	43	10	COLLAR, STOPPER .....	F10	46	3	HEAD COMP., CYLINDER .....	D1	18	3
	F8	44	14	CONDENSER .....	F1	37	17	HOLDER, FUEL FILTER .....	F6	42	8
BOLT, FLANGE, 6X20 .....	F7	43	7		F3	39	14	HOLDER, GOVERNOR WEIGHT .....	D4	21	7
BOLT, FLANGE, 6X25 .....	E2	35	4	CORD, TERMINAL .....	F1	37	5	HOUSING, RR. ....	F11	47	3
BOLT, FLANGE, 6X28 .....	D4	21	10		F3	39	5	[ I ]			
	D15	32	8	COTTER, VALVE .....	D8	25	12	INSULATOR, CARBURETOR .....	D13	30	21
	F7	43	6	COVER COMP., CRANKCASE .....	D4	21	1	INSULATOR, FR. COVER .....	F8	44	7
BOLT, FLANGE, 6X50 .....	D1	18	14	COVER COMP., FR. ....	F8	44	6	INSULATOR, LOWER MUFFLER			
	F7	43	5	COVER COMP., HEAD .....	D1	18	5	PROTECTOR F5		41	4
BOLT, FLANGE, 6X55 .....	F9	45	5	COVER COMP., RR. ....	F8	44	5	INSULATOR, RR. COVER .....	F8	44	8
	F10	46	12	COVER, FAN .....	F7	43	1	INSULATOR, SIDE MUFFLER			
BOLT, FLANGE, 6X90 .....	F11	47	7	COVER, REEL STARTER .....	F4	40	14	PROTECTOR F5		41	5
BOLT, FLANGE, 8X130 .....	F11	47	8	CRANKSHAFT COMP. ....	D6	23	1	INSULATOR, UPPER MUFFLER			
BOLT, FLANGE, 8X18 .....	F10	46	13	CUSHION, CAPACITOR .....	F2	38	18	PROTECTOR F5		41	3
BOLT, GOVERNOR ARM .....	E3	36	9		F3	39	15				
BOLT, L. CRANKCASE COVER .....	D1	18	9	CUSHION, OIL ALERT UNIT .....	F1	37	14				
BOLT, REEL COVER .....	F4	40	15		F3	39	11	[ J ]			
BOLT, SOCKET, 5X14 .....	F6	42	11	[ D ]				JET, MAIN, #50 .....	D14	31	26
BOLT, SOCKET, 6X14 .....	F7	43	11	DOWEL PIN, 8X14 .....	D1	18	13	JET, MAIN, #52.5 .....	D14	31	26
	F11	47	9		D4	21	15	JET, MAIN, #55 .....	D14	31	26
BOLT, STUD, 6X28 .....	D1	18	11	[ E ]				JET, PILOT, #32.5 .....	D14	31	27
BOLT, STUD, 6X65 .....	D1	18	10	ELEMENT, AIR CLEANER .....	D15	32	1				
BRACKET, FUEL COCK .....	F10	46	1								
BRACKET, OIL LEVEL SWITCH .....	D3	20	5								

# PART NAME INDEX

H 2

Part name	Address	Page	Ref.	Part name	Address	Page	Ref.	Part name	Address	Page	Ref.
[ K ]											
KEY, WOODRUFF .....	D6	23	2	PIN, FLOAT .....	D13	30	12	SHAFT, GOVERNOR ARM .....	D3	20	2
[ L ]											
LEVER, CONTROL .....	E3	36	6	PIN, GOVERNOR WEIGHT .....	D4	21	8	SHAFT, RATCHET .....	F4	40	6
LIFTER, VALVE .....	D8	25	9	PIN, LOCK, 8MM .....	D3	20	12	SHROUD COMP., LOWER .....	F7	43	3
[ M ]											
MARK A, CAUTION .....	F12	48	2	PIN, PISTON .....	D7	24	3	SHROUD COMP., UPPER .....	F7	43	2
MARK, CONTROL PANEL .....	F1	37	12	PIN, SPRING, 4X20 .....	F8	44	13	SLIDER, GOVERNOR .....	D4	21	9
MARK, DIRECTION .....	F12	48	3	PISTON .....	D7	24	2	SPRING .....	D13	30	5
MARK, EX. CAUTION .....	F13	49	4	PLATE A, FRICTION .....	F4	40	7	SPRING, CONTROL ADJUSTING .....	E3	36	5
MARK, FUEL .....	F12	48	5	PLATE B, FRICTION .....	F4	40	8	SPRING, COVER LOCK .....	F8	44	3
MARK, HONDA .....	F13	49	5	PLATE, SIDE .....	F4	40	13	SPRING, FRICTION .....	F4	40	9
	F12	48	1	PLUG ASSY. ....	F14	50	1	SPRING, GOVERNOR .....	E3	36	3
	F13	49	2	PLUG, SPARK .....	D1	18	8	SPRING, L. AIR CLEANER CASE .....	D15	32	5
	F13	49	3	PROTECTOR COMP., INNER MUFFLER .....	F5	41	2	SPRING, RETURN .....	F4	40	10
	F12	48	6	PROTECTOR COMP., OUTER MUFFLER .....	F5	41	1	SPRING, R. AIR CLEANER CASE .....	D15	32	4
	F13	49	6	PROTECTOR, CIRCUIT .....	F1	37	16	SPRING, THROTTLE RETURN .....	E3	36	4
	F13	49	2	PULLEY, STARTER .....	F3	39	13	SPRING, VALVE .....	D8	25	10
	F13	49	3		E1	34	2	STARTER ASSY., RECOIL .....	F4	40	1
	F12	48	6	[ R ]							
	F13	49	2	RATCHET, STARTER .....	F4	40	5	STATOR ASSY. ....	F11	47	1
	F13	49	3	RECEPTACLE .....	F1	37	7	STRAINER, FUEL .....	F6	42	2
	F12	48	6					SWITCH ASSY., ENGINE STOP .....	F1	37	15
	F13	49	6					SWITCH ASSY., OIL LEVEL .....	F3	39	12
	F13	49	6	REEL, STARTER .....	F3	39	6		D3	20	4
	D16	33	1	RETAINER, LOCK SPRING .....	F4	40	4	[ T ]			
	D16	33	2	RETAINER, VALVE SPRING .....	F8	44	2	TANK COMP., FUEL .....	F6	42	3
	D13	30	10	RING SET, PISTON .....	D8	25	11	TERMINAL ASSY., HIGH TENSION .....	E2	35	3
	D13	30	18	ROD ASSY., CONNECTING .....	D7	24	1	TUBE .....	D13	30	8
	E1	34	4	ROD COMP., PUSH .....	D8	25	3	TUBE, BREATHER .....	D1	18	7
	D13	30	25	ROD, GOVERNOR .....	D8	25	3	TUBE, CONTROL HARNESS .....	F1	37	4
	D16	33	4	ROPE, RECOIL STARTER .....	E3	36	2		F3	39	4
	E3	36	11	ROTOR COMP. ....	F4	40	12	TUBE, FUEL COCK .....	F6	42	10
	F10	46	11	RUBBER, AIR CLEANER CASE .....	F11	47	2	TUBE, FUEL TANK .....	F6	42	9
	F3	39	19	RUBBER, BOTTOM .....	D15	32	6	[ V ]			
	F2	38	24	RUBBER, FR. MOUNTING .....	F7	43	4	VALVE, CHOKE .....	D13	30	3
	F7	43	8	RUBBER, FUEL TANK .....	F10	46	4	VALVE, EX. ....	D8	25	8
	D8	25	14	RUBBER, MOUNTING .....	F11	47	4	VALVE, IN. ....	D8	25	7
				RUBBER, RR. COVER UPPER .....	F10	46	5	[ W ]			
				RUBBER, RR. MOUNTING .....	F10	46	7	WASHER .....	D13	30	19
[ O ]											
OIL SEAL, 17X30X6 .....	D3	20	9	[ S ]				WASHER, DRAIN PLUG, 10.2MM .....	D3	20	8
	D4	21	13	SCREW .....	D13	30	6	WASHER, PLAIN, 3MM .....	F3	39	20
O-RING .....	D13	30	15					WASHER, PLAIN, 4MM .....	F2	38	26
O-RING, 34.6X2.5 .....	D3	20	10	SCREW, FLAT, 3X12 .....	F3	39	16	WASHER, PLAIN, 6MM .....	D3	20	11
[ P ]											
PACKING, AIR CLEANER CASE .....	D15	32	7	SCREW, PAN, 4X12 .....	F2	38	22	WASHER, RR. COVER GROMMET .....	F8	44	10
PACKING, CASE COVER .....	D4	21	2	SCREW, PAN, 4X16 .....	E3	36	10	WASHER, SPRING, 3MM .....	F3	39	21
PACKING, FUEL FILLER CAP .....	F6	42	6	SCREW, PAN, 5X12 .....	F11	47	5	WASHER, THRUST, 6MM .....	D4	21	11
PACKING, HEAD COVER .....	D1	18	6	SCREW, PAN, 6X12 .....	F10	46	8	WASHER, WAVE, 18X7 .....	D8	25	15
PACKING, INSULATOR .....	D13	30	22	SCREW, PAN, 6X14 .....	F10	46	10	WEIGHT, GOVERNOR .....	D4	21	6
PACKING, OIL FILLER CAP .....	D4	21	4	SCREW, PILOT .....	D13	30	4	WRENCH, PLUG .....	F14	50	3
PANEL, CONTROL .....	F1	37	10	SCREW, TAPPET ADJUSTING .....	D8	25	13				
	F3	39	7	SCREW, TAPPING, 5X12 .....	F8	44	12				
	F8	44	4	SEAL, VALVE STEM .....	D8	25	1				
				SHAFT COMP., ROCKER ARM .....	D8	25	6				
				SHAFT, CHOKE .....	D13	30	2				



---

**1**

FOREWORD INDEX

---

**2**

ENGINE GROUP

---

**3**

FRAME GROUP

---

**4**

PART NUMBER INDEX

---

**5**

PART NAME INDEX

---

**HONDA**  
The Power of Dreams